

PREMIUM CLASS

SEMI-INTEGRATED 2021



c-tourer T | chic c-line T

carthago[®]
Das Reisemobil.

Table of contents

Carthago – More than just a company	3
The premium semi-integrated motorhome	8

LIGHTWEIGHT PREMIUM CLASS



c-tourer T Lightweight	10
The all-rounder: lightweight models, also within the 3.5 t weight class, compact vehicle lengths	
Models	24
Technology	31
Standard equipment	36

COMFORT PREMIUM CLASS



c-tourer Comfort	10
The all-rounder: comfort models outside of the 3.5t weight class, for fulfilling high comfort demands	
Models	24
Technology	31
Standard equipment	36



chic c-line T	38
The fascination of the Carthago Premium Class: elegance, comfort and extravagance	
Models	44
Technology	52
Standard equipment	56

The Carthago Worlds of Living	58
The Carthago Premium DNA	62
Powerful partners	80

Find out more at our Carthago website
www.carthago.com!



Additional
information



More in a film



Interactive
panorama





Carthago – More than just a company

Dear motorhome enthusiasts,

More than 40 years of the Carthago Group also means more than 40 years of the premium concept, diversity and technical know-how.

Much has grown in more than 40 years: Our head office with production and a large sales exhibition in Aulendorf in Upper Swabia, and our plant in Odranci/Slovenia. The number of employees has also increased to more than 1400, we have more than 200 partners in Germany and abroad, and the diversity of our vehicles has expanded with numerous different models. However, one thing hasn't changed - Despite the use of state-of-the-art manufacturing methods, every Carthago has been manufactured with care and a considerable amount of craftsmanship and attention to detail for more than 40 years.

We have put our heart and soul into the development of the Carthago Group. We are still a family-run company in which corporate groups and financiers don't have a say. The only people we are indebted to are you, our customers. This independence was confirmed in 2014, when the Carthago family foundation was established.

We are proud to be one of Germany's top family-run companies. As part of a representative study, 1000 family-run companies with annual turnover of up to 1 billion Euros were analysed and evaluated in accordance with the criteria of trustworthiness, quality, innovation, sustainability and their image as a company and employer. Key figures concerning turnover and personnel development and also new patent registrations were also taken into consideration. The Carthago Group achieved 24th place in the overall ranking.

The only people that the Carthago Group is indebted to are you, our customers. And we will remain a family-run company with a high level of motivation and passion, characterised by personal commitment. You can see this for yourself at trade fairs, at Carthago City or at one of our trade partners. We look forward to seeing you!

Yours, Karl-Heinz Schuler
Founder, owner and foundation chairman

The Carthago Premium DNA

*We find that
only the
best is good
enough*



Carthago has been an independent family-run company and permanent feature at the pinnacle of the motorhome industry for more than 40 years. Company founder and owner Karl-Heinz Schuler talks about what constitutes the Carthago premium DNA, why every Carthago motorhome is something very special and what unites the two at the same time.

Mr. Schuler, when did you decide to build motorhomes?

KARL-HEINZ SCHULER Panel Van Conversions caught my attention on many occasions whilst I was studying. I examined them more closely at the time, and something became clear to me in an instant: We can do better than that! The foundations for Carthago were laid with this idea and motivation.

Carthago has evolved into a premium manufacturer since 1979. Did you anticipate this success story at the time?

KARL-HEINZ SCHULER No-one could have known at the time that we would be so successful, nor could it have been planned. Our goal was always to build the best high-end motorhomes. We want satisfied customers. Success and growth then follow naturally.

What is your recipe for success?

KARL-HEINZ SCHULER The secret of our success is the Carthago inventiveness. We are the leading innovator in the motorhome industry, we maintain our quality claim with every model series, and we are a pioneer within the industry time and time again. All of this is anchored in our Carthago premium DNA.

What does Carthago Premium DNA stand for?

KARL-HEINZ SCHULER Our Carthago premium DNA is our promise of value to our customers, it can be found in every one of our motorhomes and it is motivation and an obligation at the same time. It is characterised by the Carthago bodywork, the biggest storage space system in its class, the well thought-out heating and air conditioning technology, the highest payload reserves, our driving safety and visibility concept and the Carthago personality. We are simply exceptional: our materials, our connection technology and the weight and stability demands are even similar to those of aircraft technology. Quite rightly, every sixth integrated motorhome that is registered in Europe in the price class above 85,000 Euros is a Carthago. Because a Carthago is simply unmistakable!

Long-lasting. High stability.

**Carthago Liner
premium-class
body construction**

Space guaranteed.

**Carthago double floor with
huge storage compartment**

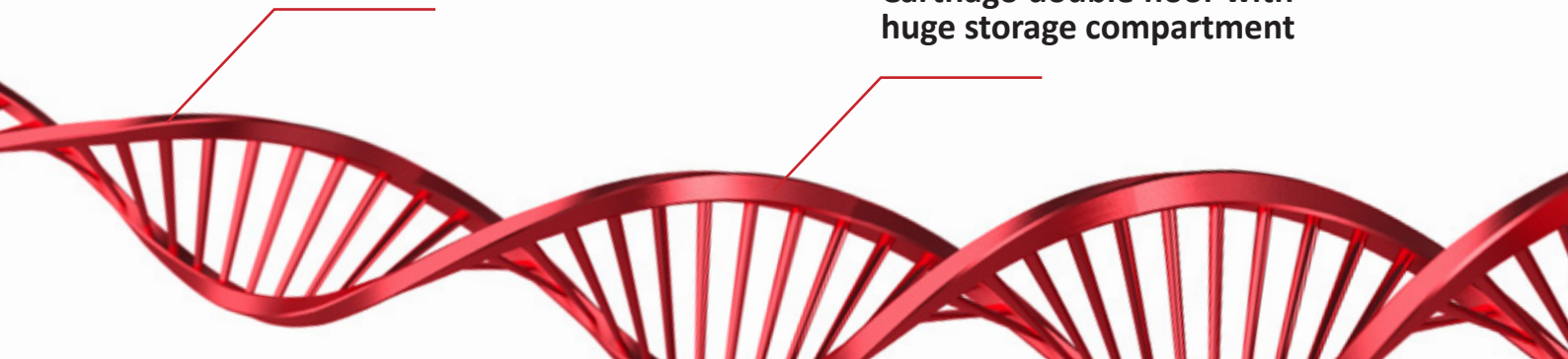



How do Carthago drivers benefit from the premium DNA?

KARL-HEINZ SCHULER Our core expertise is in motorhomes in the Liner premium class. This is because our 40 years of experience in this area flow into every stage of development and manufacturing. We think that only the best is good enough for the comfort and safety of our customers! Not only do we provide maximum durability and value retention, safety, protection and comfort. It is just as important to us to implement every idea and every innovation in practice and make everyday travelling as enjoyable as possible. This applies to all of our vehicles – be it a 3.5 tonne lightweight model or the liner class above the 3.5 t weight class. In this way, each Carthago motorhome becomes something special, and therefore a synonym for exclusivity and quality. Or, to put it simply, Carthago stands for “The Motorhome”.

Carthago city in Aulendorf is the company headquarters. What makes it special?

KARL-HEINZ SCHULER The fact that any potential customer has the opportunity to experience the Carthago premium DNA for themselves! All interested parties are welcome at Carthago City. A tour of the factory will give you an insight into perfect craftsmanship, combined with high-tech components and state-of-the-art manufacturing techniques. You can inspect the latest models at your leisure in our large showroom, arrange test drives and also rent motorhomes. It's worth making the trip to Aulendorf in Upper Swabia!

Unique. Unmistakable.
Extravagant.

Carthago Personality

Well-being – all year round.

Carthago heating & air conditioning technology

Well-balanced.
Optimum distribution.

Carthago payload & weight and balance

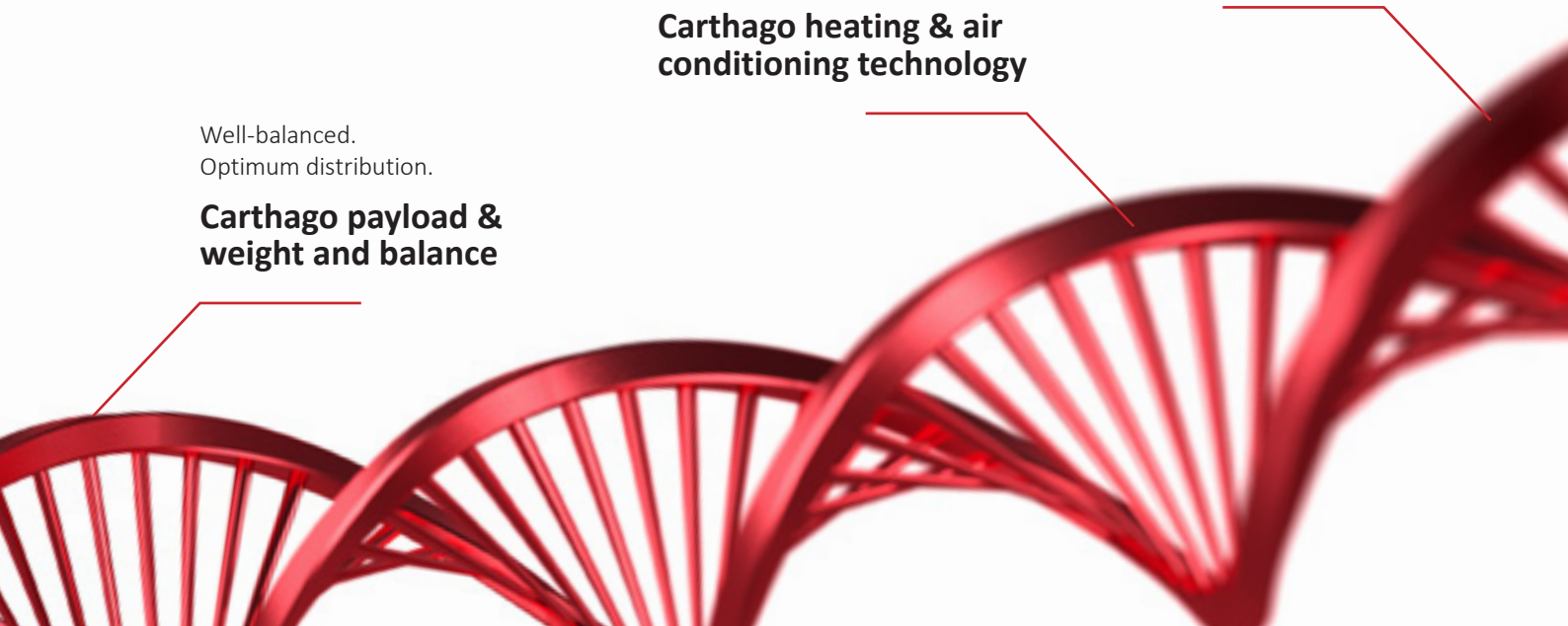



Carthago company headquarters in Aulendorf, Upper Swabia

Carthago City

Welcome

Down-to-earth and open minded at the same time, that is Carthago culture. We have remained true to our roots with the **company headquarters in Carthago City** in Aulendorf/Upper Swabia, between Ulm and Lake Constance. As well as the manufacturing facility for our premium class motorhomes, a **large sales exhibition**, the service centre for end customers and service partners as well as the company headquarters are concentrated here. You can see the combination of perfect craftsmanship with high-tech components and state-of-the-art manufacturing techniques for yourself on a **factory tour**. Of course, you are also welcome to spend the night on one of the **company pitches**.

The Carthago premium motorhome deserves premium service. About **200 dealers and service**

centres throughout Europe look after you and your Carthago motorhome. Wherever you live, wherever you roam: Carthago is never far away! The initial contact is your local dealer, and a close-knit trade and service partner network is at your side throughout Europe during your travels.

All of our dealers and service centres are trained as **certified Carthago Partners** in a multi-level academy programme. However, exceptional situations don't stop at closing time. This is why Carthago has set up an emergency breakdown number using which travellers can obtain technical assistance with problems, even at the weekend and during public holidays.



Large sales exhibition in Carthago City



Take a look behind the scenes with a factory tour! Register your preferred date on our web site at www.carthago.com

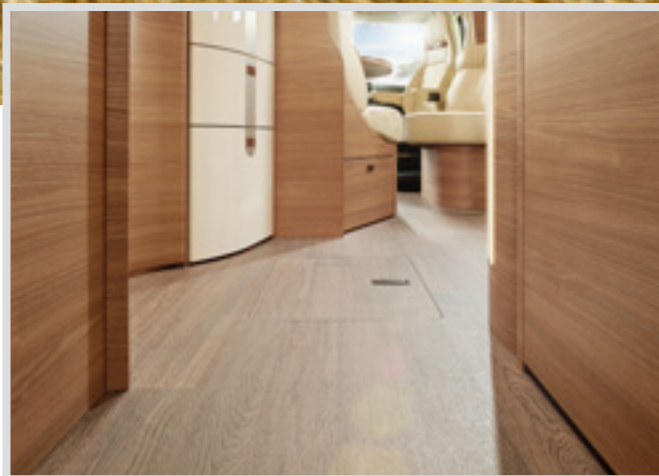

Single level living area floor from rear to driver's cab



All-round overhead storage cabinets above driver's cab with ample storage space and indirect lighting

The fascination of the premium semi-integrated

Dynamic and comfortable – simply Carthago

They are the coupés among motorhomes – flat, stylish and dynamic. The slender driver's cabin gives you a feeling of security and gives the motorhome great handling. The flat profile of the roof connection optimises the aerodynamics and gives semi-integrated motorhomes a bit of sportiness for the way.

An attractive side-effect: because of the original driver's cabin of your basic vehicle, the semi-integrated motorhomes are always somewhat more cost-effective than the elaborate integrated motorhomes. The T-models therefore represent the entry level to the world of Carthago motorhomes.



Optional central drop down bed. Electrically operated, large sleeping area, headroom beneath the bed in living mode 184 cm



Driver's cab integration in living area, large L-shaped lounge seating group with side seat bench (picture shows optional skyview skylight)



Relaxed TV viewing position: the driver's cabin seats can be rotated by 360°



Comfortable sitting position at living area table, all seats integrated

c-tourer

The All-Rounder

Lightweight models with short vehicle lengths within the 3.5 t weight class and comfort-oriented models with a gross weight of up to 4.5 t

A unique entry into the Carthago premium class: the c-tourer T has all of the advantages of a Carthago with an amazingly attractive price-performance ratio. It is a lightweight among its contemporaries at the same time. The c-tourer model range provides both floor plans for the 3.5 t weight class (optionally also up to a gross weight of 4.5 t) and comfort-oriented models with a gross weight of up to 4.5 t.



3,5 t



c-tourer Lightweight

Models: T 142 DB, T 143 LE, T 144 LE, T 144 QB, T 145 DB H

- + All lightweight models with a practical payload also in the 3.5 t weight class thanks to Carthago lightweight construction technology and short vehicle lengths of up to max. 7.10 m
- + Optionally also available with a gross weight of up to 4.5 t and therefore more payload

4,5 t



c-tourer Comfort

Models: T 148 LE H, T 148 LE, T 149 LE, T 150 QB

- + Comfort-related floor plans over a vehicle length of 7.10 m
- + Considerable feeling of spaciousness and high payload reserves with a gross weight of up to 4.5 t

4,5 t



AL-KO



Mercedes-Benz

AL-KO

Chassis

- + Fiat Ducato 35 light/40 heavy or Mercedes-Benz Sprinter*, AL-KO low frame special Carthago with 198 cm wide wheelbase rear axle
- + Fiat Ducato safety package: airbag, ESP, ABS, ASR, electric immobiliser, Hillholder, Hill Descent Control, Traction Plus / Mercedes-Benz Sprinter: airbag, side wind assistant, Hillholder, ABS, ASR, EBV, ESP



Living comfort

- + "Smartline plus" furniture design, choice of two worlds of style
- + Single level living area floor
- + L-shaped lounge seating group with side seat bench
- + Kitchen with six large drawers, professional gourmet cooker and round sink
- + Raised kitchen worktop for visual room partitioning and as additional storage area*
- + Washroom solutions: maximum comfort and separable changing room
- + Rear beds with the biggest sleeping dimensions in the class



Storage space

- + Double floor with huge, heated storage compartment, usable height up to 55.5 cm*
- + Exterior access via several large hatches, convenient access from the inside via the seat bench cover of the L-shaped lounge seating group and the lift-up side seat bench
- + Large, central through-loading space (interior height 22 cm) with extra-low double floor storage compartment (usable height 46 cm) with large living area floor hatch
- + Scooter garage: interior height up to 120 cm*, loadable up to 350 kg



Self-sufficiency / technology

- + 150 l fresh water, 140 l waste water
- + 1 x 80 Ah gel batteries (can be increased to 2 x 80 AH)



Air conditioning/heating

- + Truma Combi 6 warm air storage heating system, optional: ALDE warm water central heating*
- + Double floor with underfloor heating effect



AL-KO



Mercedes-Benz

AL-KO

Many c-tourer models also available on Mercedes-Benz Sprinter with AL-KO low frame - see model overview and price list!



c-tourer T 143 LE in Casablanca world of style and Cambridge world of living

360°

c-tourer T Lightweight

c-tourer T Comfort





c-tourer T 150 QB in epic two-tone world of style and San Remo world of living



c-tourer T Lightweight

c-tourer T Comfort

Living area features

- + Standard: epic two-tone world of style with furniture surfaces with a modern two-tone look, optional: Casablanca world of style
- + Living area table with chrome piping, can be rotated by 360° and moved using a foot pedal
- + Indirect ambient lighting with separate control from the main light, numerous spotlights with LED lighting technology
- + Level passage from living room to driver's cabin without tripping hazards



Model T 143 LE

L-shaped lounge seating group with swing-out side seat bench

- + TV pull-out system above L-shaped lounge seating group for optional 24" LED flat screen or optional elegantly integrated TV cabinet including 32" LED flat screen
- + Raised kitchen worktop for visual room partitioning and as additional storage area
- + Swivel-out shoe cabinet with holding system integrated in plinth of seat bench, including LED mood lighting

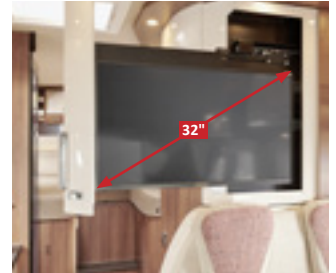

Elegantly integrated TV cabinet including 32" LED flat screen (optional)



Models T 144 LE, T 144 QB

L-shaped lounge seating group with lift-up side seat bench

- + TV wall bracket in entrance area combination cabinet for optional 24" LED flat screen
- + Raised kitchen worktop for visual room partitioning and as additional storage area
- + Swivel-out shoe cabinet with holding system integrated in plinth of seat bench, including LED mood lighting



Flat screen with wall bracket in entrance area



Models T 142 DB, T 148 LE, T 149 LE, T 150 QB

Large L-shaped lounge seating group with wide, lift-up side seat bench, optional 5th belted seat

- + TV pull-out system behind the side seat bench backrest for optional 24" LED flat screen
- + Raised kitchen worktop for visual room partitioning and as additional storage area
- + Swivel-out shoe cabinet with holding system integrated in plinth of seat bench, including LED mood lighting



TV pull-out system behind side seat bench backrest

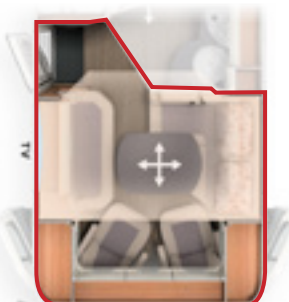

Models T 145 DB H, T 148 LE H

Large L-shaped seating group with long side sofa, optional 5th belted seat

- + TV pull-out system behind the side seat bench backrest for optional 24" LED flat screen



TV pull-out system behind side seat bench backrest



L-shaped lounge seating group with wide side seat bench (T 150 QB)



Swing-out shoe cabinet and holder system for up to four pairs of shoes beneath L-shaped lounge seating group (not T 145 DB H, T 148 LE H)



The fine details of the world of living design and the transition from the living area to the kitchen differ in models T 145 LE H and T 148 LE H



They provide organisation and blend perfectly into the interior: the Carthago clothes hooks



c-tourer T 143 LE in Casablanca world of style and Cambridge world of living, with optional skyview skylight

Kitchen highlights

- + "Professional gourmet" 3-ring hob with divided glass cover, robust cast iron trivet and easy-clean glass surface
- + Kitchen units with six large drawers and integrated waste bin
- + Designer overhead storage compartment in vertical waveform
- + Sink cover embedded flush in the surface, can be used as additional work surface/chopping board
- + Optional: capsule coffee maker with pull-out system in overhead storage cabinet



Model T 143 LE

Space-saving galley kitchen

- + Short vehicle length
- + 133 l Slimtower refrigerator with door which opens at both sides and separate freezer compartment at convenient hand height
- + Raised kitchen worktop for visual room partitioning and as additional storage area



Optional: capsule coffee maker with pull-out system in overhead storage cabinet

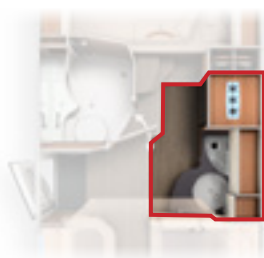

Models T 145 DB H,
T 148 LE H

Corner kitchen

- + Large work surface
- + 153 l refrigerator with door which opens at both sides and separate freezer compartment at convenient hand height
- + Kitchen units with ambient plinth lighting from below



Large 153 l refrigerator at hand height



Models T 142 DB, T 144 LE,
T 144 QB, T 148 LE

Corner kitchen

- + Large work surface
- + 133 l refrigerator opposite with door which opens at both sides and separate freezer compartment (T 144 LE, T 144 QB)
- + 153 l refrigerator opposite with door which opens at both sides and separate freezer compartment (T 142 DB, T 148 LE)
- + Raised kitchen worktop for visual room partitioning and as additional storage area
- + Spice rack on kitchen wall (T 142 DB, T 148 LE)
- + Kitchen units with ambient plinth lighting from below



Practical spice rack (T 142 DB, T 148 LE)

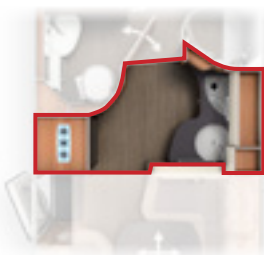

Models T 149 LE, T 150 QB

Luxury corner kitchen

- + Curved, extra large work surface, extended into the round washroom wall
- + 153 l fridge opposite with door which opens at both sides and separate freezer compartment at convenient hand height
- + Raised kitchen worktop for visual room partitioning and as additional storage area
- + Kitchen units with ambient plinth lighting from below



Securely stored: practical bottle cabinet



Luxury corner kitchen in Casablanca world of style (T 149 LE, T 150 QB)



Space-saving galley kitchen in epic two-tone world of style (T 143 LE)



Corner kitchen with spice rack in Casablanca world of style (T 142 DB, T 148 LE)



Tremendous amount of storage space in the six large drawers



Use of the sink cover via the wall holder with cutting board function

Washroom and changing room highlights

- + Solid washroom door with strong hinges, metal handle and door lock
- + Shower room can be completely separated from the washroom whilst showering
- + Spacious wash stand base unit
- + Numerous shelves
- + Mini-Heki skylight in washroom



Models T 143 LE, T 145 DB H, T 148 LE H

Combined washroom

- + Large, round shower that can be separated via a sliding door
- + Large mirror storage cabinet with shelves
- + Integrated shower shelf and towel rail in the roof light
- + Waterproof shower insert with same design as living area floor (optional)



Separate round shower



Models T 142 DB, T 148 LE

Combination washroom with changing area

- + Separate round shower
- + Large mirror storage cabinet with shelves
- + Separation from living area as changing room via the room dividing function of the washroom door
- + Additional partitioning from the sleeping area via the sliding door (T 148 LE)
- + Changing room with room-high wardrobe
- + Integrated shower shelf and towel rail in the roof light
- + Waterproof shower insert with same design as living area floor (optional)



Changing room with room divider



Compact luxury washroom, models T 144 LE, T 144 QB

Compact or comfort luxury washroom with changing room

- + Spacious washroom / toilet room with shower opposite
- + Waterproof shower insert with same design as living area floor
- + Separation from living area as changing room via the room dividing function of the washroom door or sliding door
- + Comfort luxury washroom with additional partitioning of the sleeping area via the sliding door (T 149 LE)
- + Comfort luxury washroom with additional partitioning of sleeping area by pull-out room partitioning and TV wall (T 150 QB)



Comfort luxury washroom, models T 149 LE, T 150 QB



Combined washroom: Washroom / toilet area with separate round shower
(T 142 DB, T 148 LE)



Washroom with washbasin and toilet (T 144 LE, T 144 QB)



Comfort luxury washroom with changing room (T 149 LE, T 150 QB)

Sleeping area features

- + Extra large sleeping areas
- + Two-part heated and ventilated slatted frame with flexibly supported wooden slats
- + High quality 7-zone cold foam mattress with breathable climate quilting

- + Wardrobes with extra-large interior height due to lowering into the double floor
- + Optional: World of sleeping and decoration set with made-to-measure elasticated covers



Models T 142 DB, T 145 DB H

Rear transverse bed

- + Bed access via large entry steps
- + Large wardrobe beneath bed
- + Room-high wardrobe



Wardrobe beneath transverse rear bed



Models T 143 LE, T 148 LE, T 148 LE H, T 149 LE

Lengthways single beds

- + Adjustable head sections (passenger side only in T 144 LE), sleeping area extension between the beds with additional mattress
- + Sleeping area can be moved by 30 cm for a sleeping length of 200 cm, large luxury washroom and short vehicle length (T 144 LE)
- + Wardrobes beneath the lengthways single beds, conveniently accessible from front and above via the lift function
- + Pull-out access steps for accessing the bed (T 143 LE)
- + Pull-out comfort access steps with extra-deep treads and additional storage compartment (T 148 LE, 148 LE H, 149 LE; optional for T 143 LE)



Model T 144 LE

Registered for patent approval.⁽¹⁾
Pull-out sleeping area



Model T 144 QB

Queen-size bed

- + Sleeping area can be moved by 30 cm for comfortable living and sleeping configuration with a short vehicle length. Living configuration: convenient access to wardrobes. Sleeping configuration: Sleeping length 195 cm (T 144 QB)
- + Adjustable head section
- + Wardrobes on each side of the queen-size bed
- + Large pull-out at front of queen-size bed
- + Lift-up mattress at passenger side for extra-wide passage (T 150 QB)



Model T 150 QB



Optional: TV cabinet for lengthways single bed models (except T 144 LE)



Large rear transverse bed with all-round overhead storage cabinets (T 142 DB)



Wardrobes beneath the lengthways single beds, conveniently accessible from front and above via the lift function



Large lengthways single beds with raisable head section and access steps. Convenient access to wardrobes below from front and above thanks to lift function (T 143 LE, T 148 LE, T 148 LE H, T 149 LE)



Registered for patent approval: Sleeping area can be extended by 30 cm for comfortable living and sleeping configuration within a short vehicle length (T 144 QB)



Pull-out single bed with access steps (T 144 LE)

c-tourer T 142 DB Lightweight



AL-KO



Registered for patent approval. ⁽¹⁾
Leading by means of innovation!

Changing room with room dividing function



c-tourer T 143 LE Lightweight



AL-KO



Mercedes-Benz
AL-KO

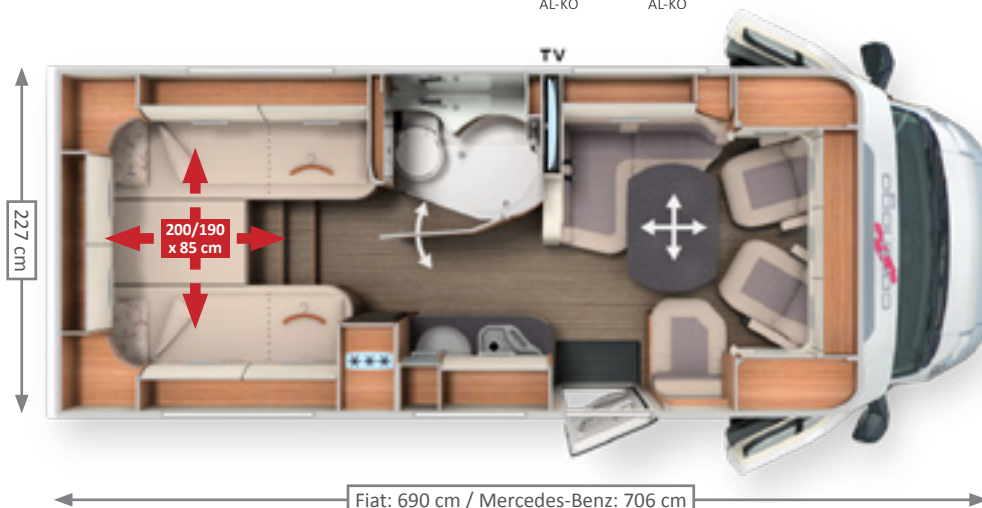

c-tourer T 144 LE Lightweight



AL-KO



Registered for patent approval. ⁽¹⁾
Leading by means of innovation:

Pull-out lengthways single bed



MODEL HIGHLIGHTS

- + Short vehicle length specifically for the 3.5 t weight class, L-shaped lounge seating group with side seat bench, large transverse rear bed
- + Corner kitchen with large work surface and kitchen units with ambient plinth lighting from below
- + Raised kitchen worktop for visual room partitioning and as additional storage area
- + Separation from living area as changing room via the room dividing function of the washroom door
- + Combined washroom with round shower
- + Room-high wardrobe
- + Additional wardrobe beneath the rear bed



Chassis	Weight ready to drive	Payload up to	Seats with three-point seat belt	Berths
Fiat Ducato AL-KO Low frame 35 light	2,915 kg	1,545 kg	4/5*	2/4*

- + All-rounder: lots of comfort, short vehicle length, light weight
- + L-shaped lounge seating group with side seat bench
- + Compact galley kitchen
- + Raised kitchen worktop for visual room partitioning and as additional storage area
- + Combined washroom with round shower and practical drying rail in the Mini-Heki
- + Changing room can be partitioned off by washroom door
- + Wardrobes beneath lengthways single beds with extra-large interior height due to lowering into the double floor
- + Pull out step for easy access to bed, optional pull-out comfort access step with extra-deep treads and additional storage compartment
- + Optional: TV cabinet in sleeping area with special TV pull-out system



Chassis	Weight ready to drive	Payload up to	Seats with three-point seat belt	Berths
Fiat Ducato AL-KO Low frame 35 light	2,905 kg	1,555 kg	4	2/3*
Mercedes-Benz Sprinter AL-KO Low frame	2,945 kg	1,525 kg	4	2/3*

- + Unique: L-shaped lounge seating group, side seat bench, corner kitchen, luxury washroom and lengthways single beds up to 200 cm long with a vehicle length of just under 7 m
- + Corner kitchen with large work surface and kitchen units with ambient plinth lighting from below
- + Raised kitchen worktop for visual room partitioning and as additional storage area
- + Living area partitioning by means of sliding door
- + Compact luxury washroom with separate shower
- + Lengthways single bed at passenger-side, movable by 30 cm: 200 cm sleeping length in sleeping configuration / spacious shower room in living configuration
- + Access steps for easy access to bed
- + Wardrobes beneath lengthways single beds with extra-large interior height due to lowering into the double floor



Chassis	Weight ready to drive	Payload up to	Seats with three-point seat belt	Berths
Fiat Ducato AL-KO Low frame 35 light	2,985 kg	1,475 kg	4	2/4*

c-tourer T 144 QB Lightweight



AL-KO

3,5 t

4,5 t

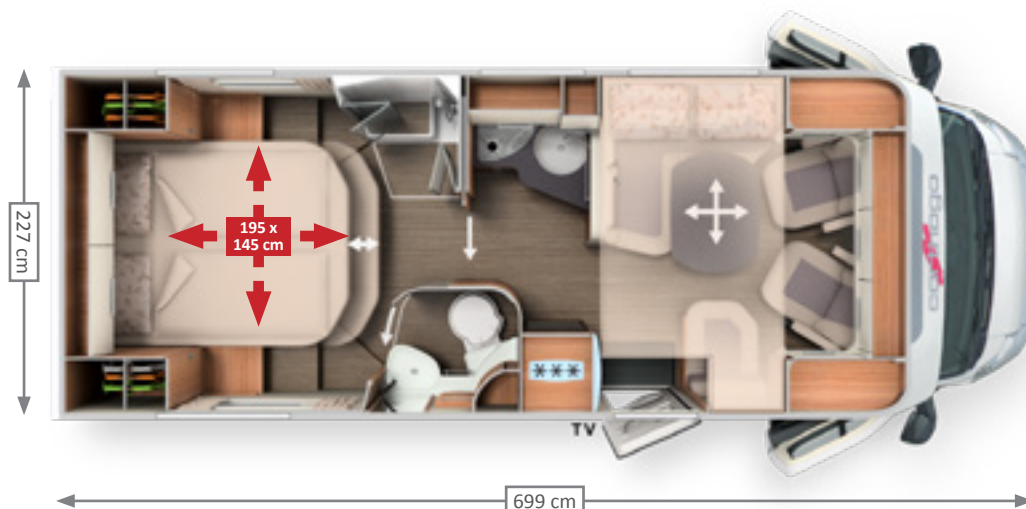

Registered for patent approval. ⁽¹⁾
Leading by means of innovation:

Pedelec scooter garage; Pull-out queen-size bed

c-tourer T 145 DB H Lightweight



AL-KO

3,5 t

4,5 t

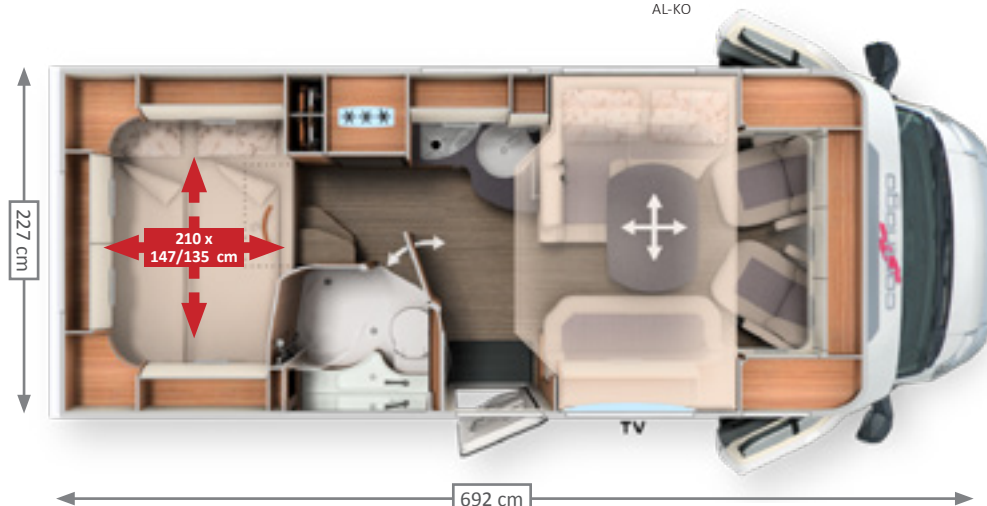

c-tourer T 148 LE H Comfort



AL-KO



Mercedes-Benz
AL-KO

3,5 t

4,5 t

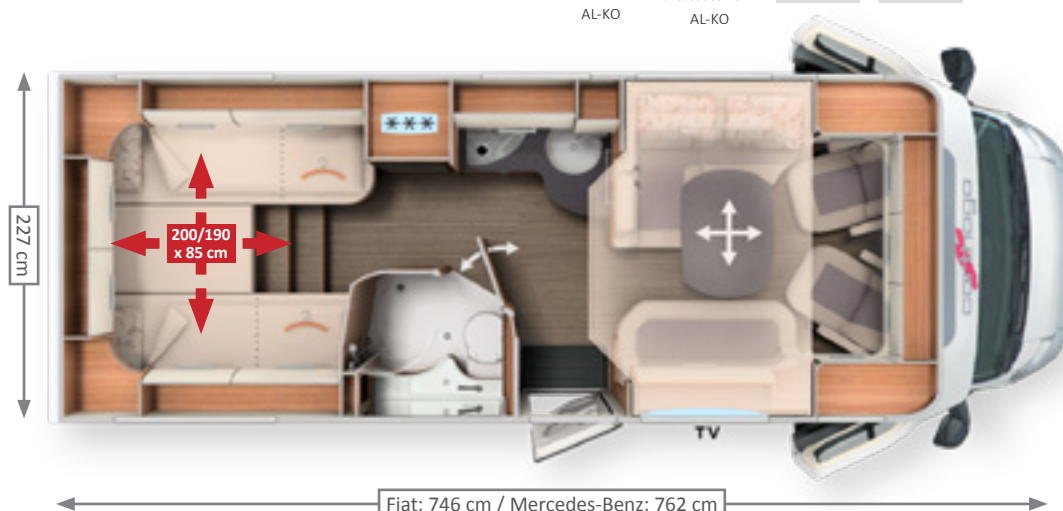

Registered for patent approval. ⁽¹⁾
Leading by means of innovation:

Pull-out comfort access steps

MODEL HIGHLIGHTS

- + Unique: L-shaped lounge seating group, side seat bench, corner kitchen, luxury washroom and 195 cm queen-size bed with a vehicle length of just under 7 m
- + Corner kitchen with large work surface and kitchen units with ambient plinth lighting from below
- + Raised kitchen worktop for visual room partitioning and as additional storage area
- + Living area separated off by solid sliding door, therefore separate changing room
- + Compact luxury washroom with separate shower
- + Queen-size bed can be moved by 30 cm: 195 cm sleeping length in sleeping configuration / spacious access to the wardrobes in living configuration, comfortable sleeping width as far as the foot area
- + Two wardrobes at each side of the queen-size bed
- + Large pull out drawers at front of queen-size bed



Chassis	Weight ready to drive	Payload up to	Seats with three-point seat belt	Berths
Fiat Ducato AL-KO Low frame 35 light	2,985 kg	1,475 kg	4	2/4*

- + Short vehicle length specifically for the 3.5 t weight class with L-shaped lounge seating group and long side sofa, large rear transverse bed
- + Optional: central drop-down bed with wide sleeping area for two persons
- + Corner kitchen with large work surface
- + Combined washroom with separable round shower
- + Room-high wardrobe
- + Additional wardrobe beneath the rear bed



Chassis	Weight ready to drive	Payload up to	Seats with three-point seat belt	Berths
Fiat Ducato AL-KO Low frame 35 light	2,935 kg	1,525 kg	4/5*	2/5*

- + Comfort-related floor plan: large L-shaped seating group, wide side seat bench, corner kitchen, room high wardrobe
- + Optional: central drop-down bed with wide sleeping area for two persons
- + Corner kitchen with large work surface and kitchen units with ambient plinth lighting from below
- + Combined washroom with separable round shower
- + Wardrobe with extra large interior height beneath the lengthways single beds
- + Optional: TV cabinet in sleeping area with special TV pull-out system
- + Lengthways single beds up to 200 cm long with patented pull-out comfort access steps with extra-deep treads and additional storage compartment

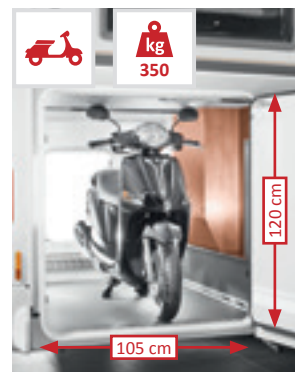

Chassis	Weight ready to drive	Payload up to	Seats with three-point seat belt	Berths
Fiat Ducato AL-KO Low frame 35 light	2,995 kg	1,465 kg	4/5*	2/5*
Mercedes-Benz Sprinter AL-KO Low frame	3035 kg	1435 kg	4/5*	2/5*

c-tourer T 148 LE Comfort

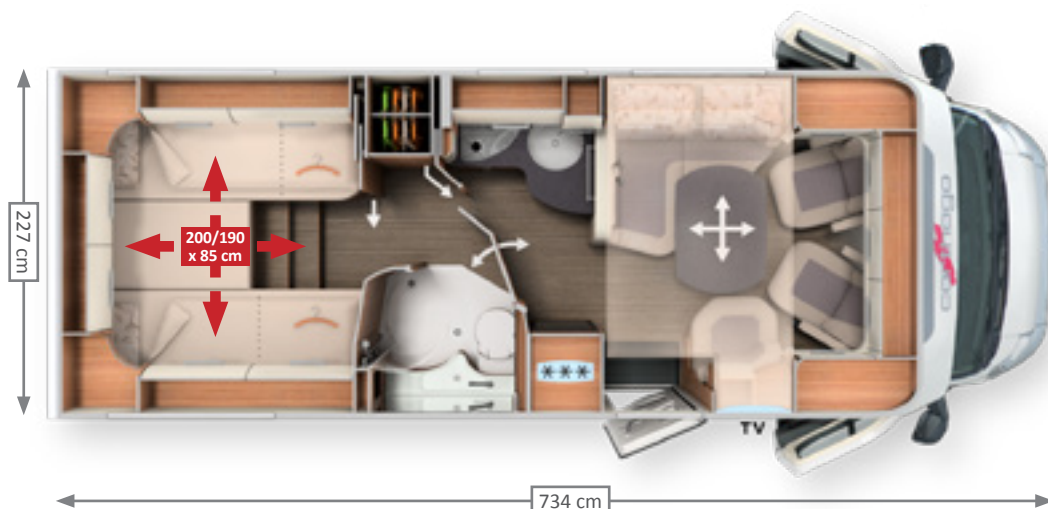

Registered for patent approval. ⁽¹⁾
Leading by means of innovation:

Changing room with room dividing function;
Pull-out comfort access steps

c-tourer T 149 LE Comfort

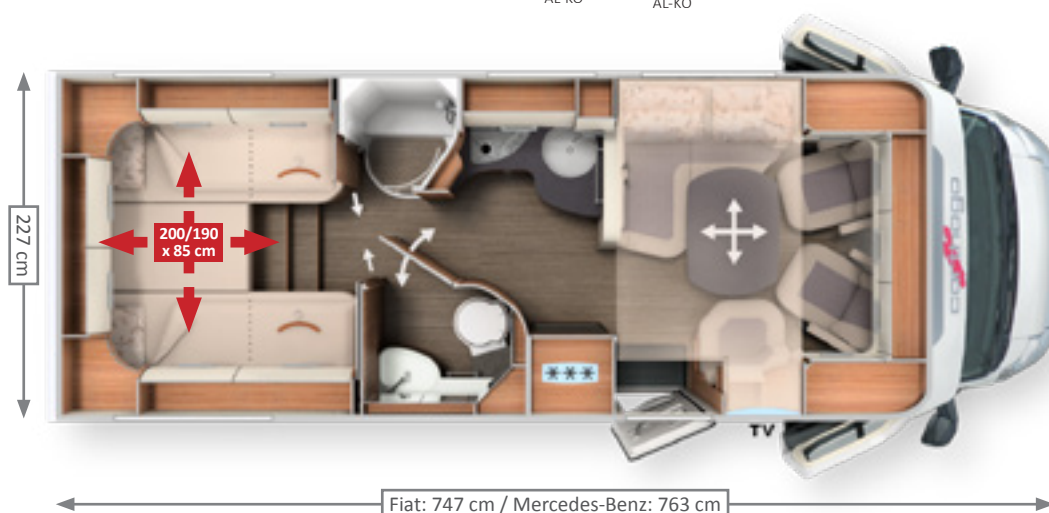

Registered for patent approval. ⁽¹⁾
Leading by means of innovation:

Pull-out comfort access steps

c-tourer T 150 QB Comfort

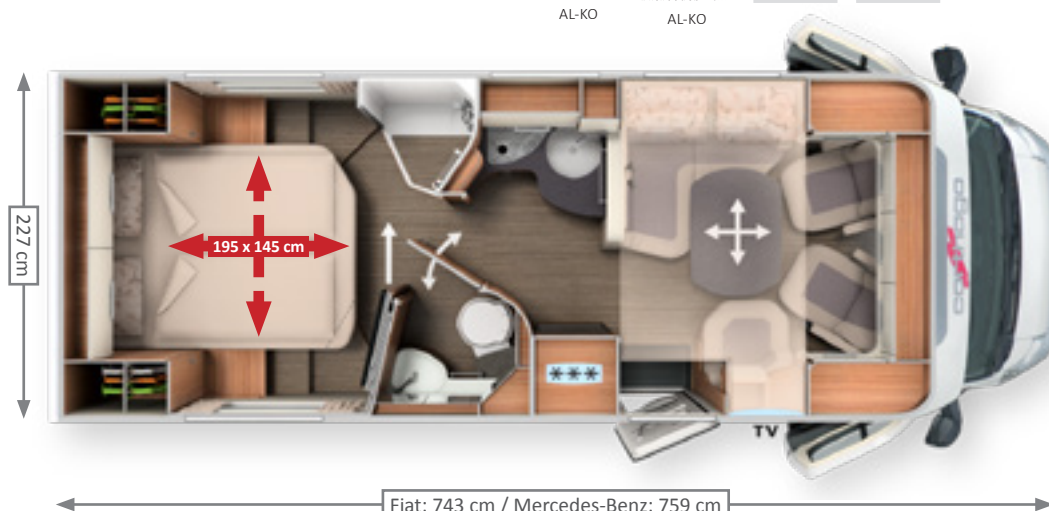

Registered for patent approval. ⁽¹⁾
Leading by means of innovation:

Pedelec scooter garage; Pull-out partitioning and TV wall

MODEL HIGHLIGHTS

- + Comfort-related floor plan: large L-shaped seating group, wide side seat bench, corner kitchen, room high wardrobe
- + Corner kitchen with large work surface and kitchen units with ambient plinth lighting from below
- + Raised kitchen worktop for visual room partitioning and as additional storage area
- + Combined washroom with round shower, washroom door with room dividing function and practical clothes pole in the Mini-Heki
- + Changing area with sliding door to sleeping area
- + Room-high wardrobe, additional wardrobes with extra-large interior height beneath the lengthways single beds
- + Lengthways single beds up to 200 cm long with pull-out comfort access steps with extra-deep treads and additional storage compartment
- + Optional: TV cabinet in sleeping area with special TV pull-out system



Chassis	Weight ready to drive	Payload up to	Seats with three-point seat belt	Berths
Fiat Ducato AL-KO Low frame 35 light	3,015 kg	1,445 kg	4/5*	2/4*

- + Large L-shaped lounge seating group with wide side seat bench
- + Large corner kitchen with curved work surface and kitchen units with ambient plinth lighting from below
- + Raised kitchen worktop for visual room partitioning and as additional storage area
- + Comfort luxury washroom with changing room by means of sliding door in sleeping area and washroom door room dividing function
- + Lengthways single beds 200 cm long with pull-out comfort access steps with extra-deep treads and additional storage compartment
- + Wardrobes beneath the lengthways single beds with large interior height
- + Optional: TV cabinet in sleeping area with special TV pull-out system



Chassis	Weight ready to drive	Payload up to	Seats with three-point seat belt	Berths
Fiat Ducato AL-KO Low frame 35 light	3,015 kg	1,445 kg	4/5*	2/4*
Mercedes-Benz Sprinter AL-KO Low frame	3,055 kg	1,415 kg	4/5*	2/4*

- + Comfort Plus floor plan
- + Large L-shaped lounge seating group with wide side seat bench
- + Large corner kitchen with curved work surface and kitchen units with ambient plinth lighting from below
- + Raised kitchen worktop for visual room partitioning and as additional storage area
- + Comfort luxury washroom with changing room by means of room partitioning
- + Pull-out room divider and TV wall for individual room partitioning between sleeping/changing area
- + Large queen-size bed, convenient bed access, comfortable sleeping width as far as the foot area
- + Two wardrobes at each side of the bed
- + Lift-up mattress at passenger side for extra-wide passage



Chassis	Weight ready to drive	Payload up to	Seats with three-point seat belt	Berths
Fiat Ducato AL-KO Low frame 35 light	3,015 kg	1,445 kg	4/5*	2/4*
Mercedes-Benz Sprinter AL-KO Low frame	3,055 kg	1,415 kg	4/5*	2/4*

c-tourer

Exterior



AL-KO



Mercedes-Benz
AL-KO

Standard light grey/white

Bodywork light grey/white, vehicle front white, A-pillar, front, side, rear skirt and wheel arches white

Fiat Ducato



Mercedes-Benz Sprinter



Driver's cabin design

c-tourer Comfort T 150 QB on Fiat Ducato with San Remo world of living



c-tourer Lightweight T 143 LE on Mercedes-Benz Sprinter with Cambridge world of living



Carthago lightweight construction technology

“Lightweight”

Down with the weight, up with the quality - specially for the 3.5 t weight class

Extremely stable and super light: Carthago is the pioneer for intelligent lightweight construction throughout the industry. Intelligent means: Carthago reduces the weight, but not the customary comfort or quality. The Carthago semi-integrated c-tourer Lightweight vehicles are the

lightest models in their class. With maximum stability, quality, maximum comfort and a comprehensive range of equipment. The consistent lightweight construction technology has many benefits: more payload, lower fuel consumption and fewer emissions at the same time.

Your added value with Carthago

- + **Outstanding agility and lighter weight** due to short vehicle lengths
- + **More payload** also in the 3.5 t weight class
- + **Lower fuel consumption**
- + **Fewer restrictions** because of road traffic regulations
- + **Fewer toll charges**

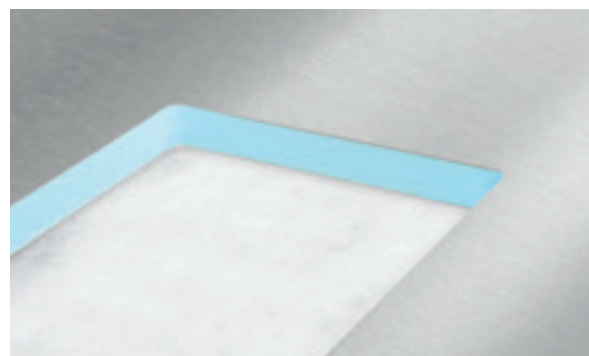

The Carthago main body construction technology is very stable and light. The combination of aluminium on the outside and the inside and the RTM hard foam insulating core which are typical of the brand allows Carthago to dispense with weight-intensive wall reinforcements



Lightweight premium class
Carthago lightweight construction technology, specially for the 3.5 t weight class



Carthago weight-optimised furniture design: thanks to the piping technology, the curved and rounded moulded furniture parts have high stability and less weight at the same time



With the self-supporting main body and the light AL-KO low frame, the Carthago double floor contributes to providing maximum stability and torsional rigidity



Usable height
up to 55.5 cm

Double floor with huge storage compartment

EASY ENTRY – convenient loading from the outside,
easy removal from the inside



PASSENGER SIDE

Gas bottle compartment



Rear garage
can be loaded
with up to
350 kg

Scooter garage with considerable interior height thanks to deep lowering, accessible at both sides via a large door at the driver's side and a second door at the passenger side

Load from the outside



Convenient loading of the double floor storage compartment via a large external hatch (at the passenger side)

Unload from the inside



Easy removal of storage compartment contents from the inside via the lift-up seat bench cover of the L-shaped lounge seating group

Additional double floor storage



Living area floor hatch with double floor storage box (42 cm usable depth) in heated double floor

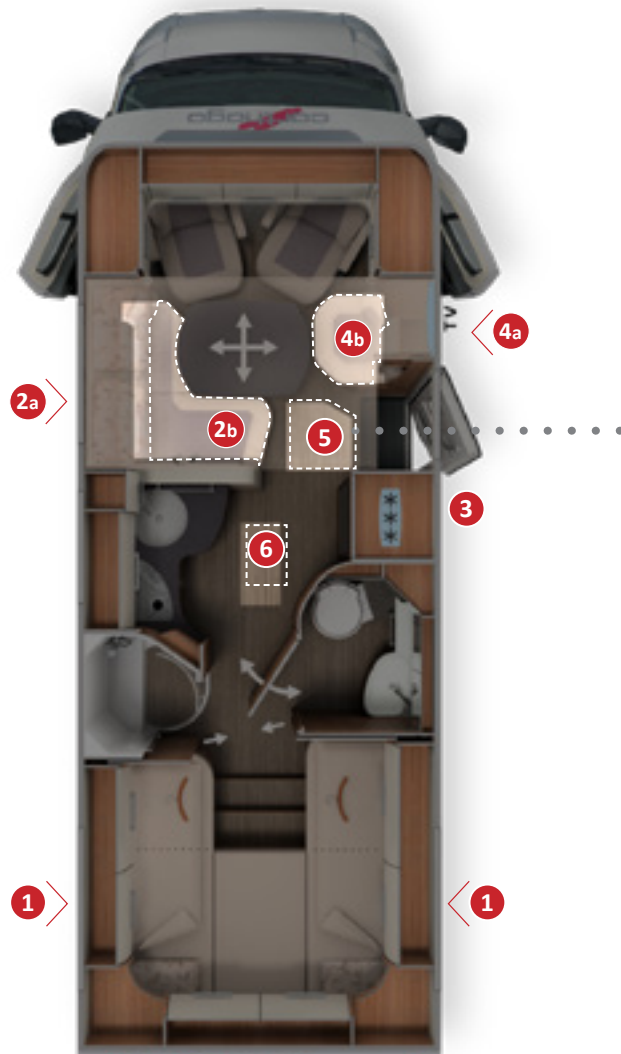



- + **Double floor** with huge, heated storage compartment, usable height up to **55.5 cm**
- + **Exterior access** via several large hatches
- + Convenient **interior access** via L-shaped lounge seating group seat bench cover, lift-up side seat bench and the large living area floor hatch
- + **Large, central through-loading space** (interior height 22 cm), with extra-low double floor storage compartment (usable height 46 cm), convenient loading through the entrance door via a large, adjustable living area floor hatch
- + The entire double floor is heated with a **climate storage function** and underfloor heating effect



DRIVER'S SIDE



Large, additional double floor storage compartment with separate exterior hatch (driver's side)



Convenient loading of the double floor storage compartment via a large external hatch (depending on model)

Load from the outside



Huge living area floor hatch in the entrance area: easy to load from the outside when main cabin door is open



Convenient removal of contents via lift-up side seat bench

Unload from the inside



On-board technology

Electrical technology, water supply, warm air storage heating technology

C



Warm air storage

heating system Truma Combi 6



Double floor

with climate storage function and underfloor heating effect



Capacity

150 l fresh water tank
140 l waste water tank
1 x 80 Ah gel battery
(can be increased to 2 x 80 Ah)



Targeted heating of driver's cabin area via additional warm air outlet under driver's cabin seat



Truma Combi 6 heat storage heating system with numerous warm air outlets in the entire double floor, the living area, the rear garage, the driver's cabin and the cold-sensitive door entrances



"easy change" gas bottle compartment, extra-low for convenient bottle changing (except T 143 LE)

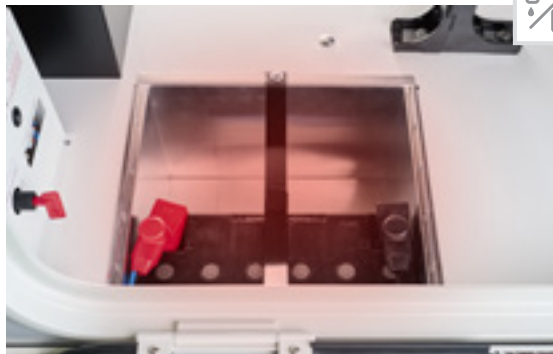

Heated battery centre with main battery switch; Standard: Gel batteries 1 x 80 Ah, can be increased to 2 x 80 Ah, optional Lithium ion battery 90 Ah including battery computer



Easily accessible electric centre in the rear garage

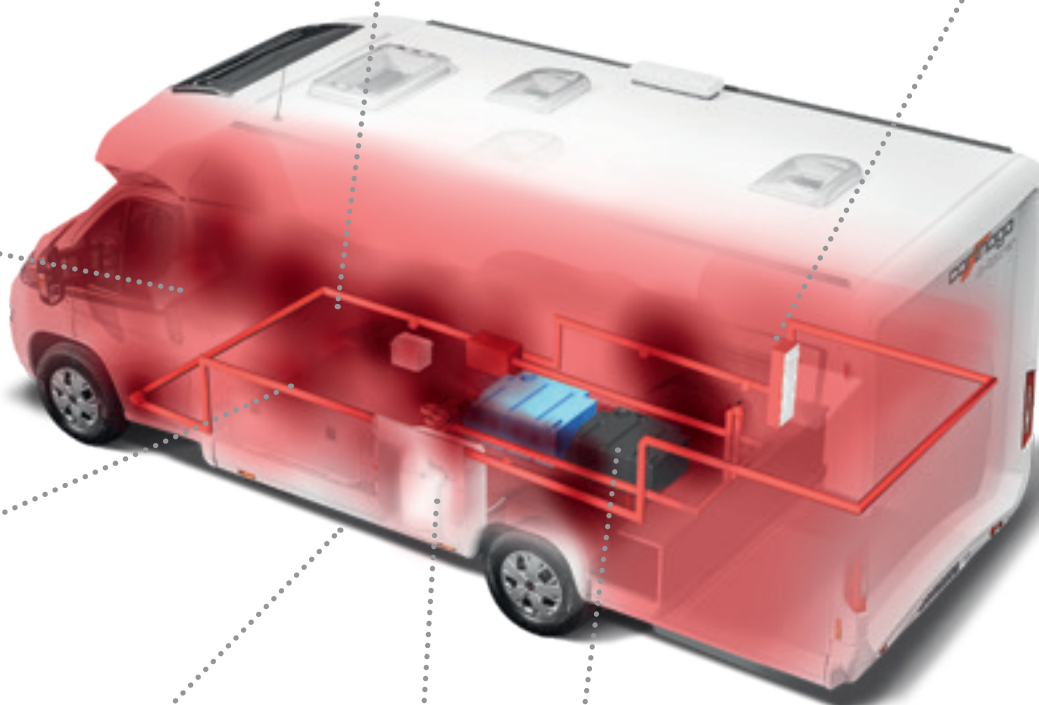

Gas bottle compartment (model T 143 LE) with easy access via separate gas compartment door. Optional: comfort gas bottle pull-out system



Central water drain in the double floor – can also be operated from the outside through the main cabin door

GRP front mask



above the driver's cabin, attractive shape, high-quality GRP, jointed and insulated all-round

Main cabin door "premium one"



with door limiter and door window

Central locking



using hand transmitter in the main key for the drivers cabin doors

Driver's cabin pilot seats



with upholstered armrests, adjustable

Electrical entrance step



for the living area: extracted / retracted electrically

High quality seat upholstery



with multilayer premium foam core and back support function

Ambient plinth lighting from below



in living and kitchen area (depending on model)

Overhead storage cabinets as standard



with optional coffee machine pull-out system

Living area on one level



continuous from driver's cabin to the sleeping area

Swing-up shoe cabinet



beneath the lounge seating group in the entrance area with shoe storage system for up to 4 pairs of shoes (except T 145 DB H, T 148 LE H)

Kitchen worktop



with scratch resistant surface in shale décor, lit from underneath with LED light strip and practical worktop extension

Individual lighting control



separate control of main light and ambient lighting possible



AL-KO

chic c-Line

The fascination of the Carthago Premium Class

Elegance, comfort and extravagance

Luxurious, extravagant, comfortable and thoroughly practical: the chic c-line T comes up trumps with regard to payload, storage space, top class driving comfort, modern design and pure living comfort. Its charm sets the chic c-line T apart from the wide range of semi-integrated vehicles that are available on the market.

4.5 t



Weight class

- + Comfort-conscious floor plans with up to 4.5 t permissible gross vehicle weight



AL-KO

Chassis

- + Fiat Ducato with AL-KO low frame 35 light/40 heavy, wide wheelbase rear axle, 198 cm
- + Fiat Ducato safety package: Airbag, ABS, ESP, ASR, electric immobiliser, hill holder, Hill Descent Control, Traction Plus
- + Optional: Fiat driver's assistance package



Living comfort

- + "Exclusiveline" furniture design, flowing stylistic architecture, rounded, exclusive furniture surfaces, two worlds of style to choose from
- + L-shaped lounge seating group with side bench and rectangular living room table
- + Comfortable corner kitchen with coffee machine lift and slide-out storage cabinet
- + Washroom variants with outstanding comfort and separate changing room
- + Fixed beds with Carawinx sleeping system



Storage space

- + Double floor with huge heated storage compartment, usable height up to 70 cm
- + Exterior access via several large hatches, convenient access from the inside via the seat bench cover of the L-shaped lounge seating group and the lift-up side seat bench
- + Large, central through-loading space (interior height 22 cm), with extra-low double floor storage compartment (usable height 46 cm), convenient loading inside and outside via a large, adjustable living area floor hatch
- + Scooter garage: interior height up to 120 cm*, loadable up to 350 kg



Self-sufficiency / technology

- + 170 l fresh water, 140 l waste water
- + 2 x 80 Ah gel batteries



Air conditioning/heating

- + Truma Combi 6 warm air storage heating system optional Alde warm water central heating
- + Double floor with underfloor heating effect



chic c-line

chic c-line T 4.8 LE in linea classica world of style and leather Sand 21
world of living



chic c-line



chic c-line T 4.9 LE in linea moderna world of style and part-leather ivory world of living



chic c-line

chic c-line T 4.8 LE



Registered for patent approval.⁽¹⁾
Leading by means of innovation.

Changing room with room dividing function;
Pull-out comfort access steps

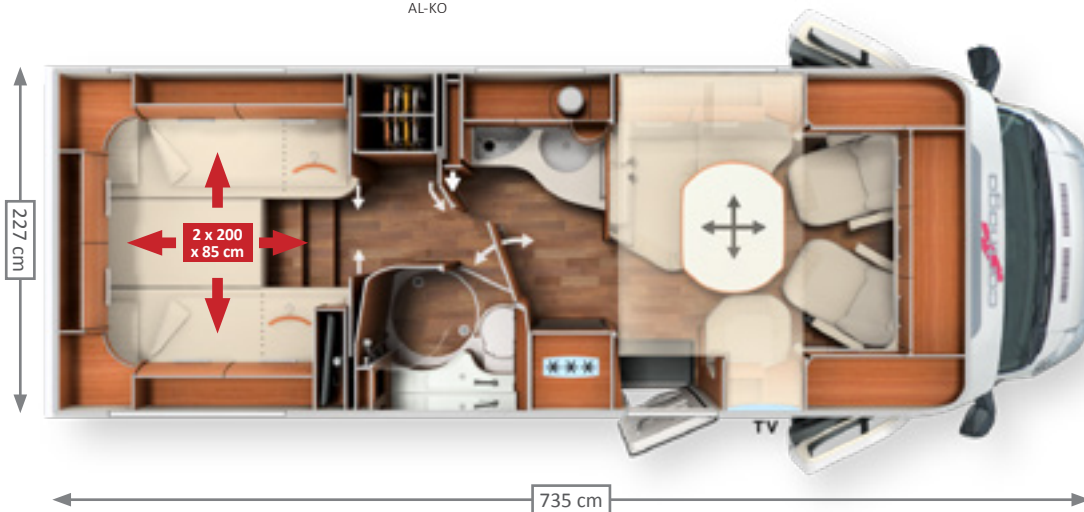

Large L-shaped lounge seating group with side seat bench

- + Rectangular living room table with chrome piping, optional 5th belted seat
- + Pull out system for 24" LED flat screen behind side seat bench back rest

- + Washroom door with room dividing function from living area

- + Solid wooden sliding door for separating the changing room from the sleeping area

- + Room-high wardrobe



Corner kitchen

- + Large work surface
- + Kitchen area with six large drawers, centre drawer with integrated waste bins
- + "Professional gourmet" 3-ring hob with 2 part glass cover, robust cast iron trivet and easy-clean glass surface
- + 153 l fridge with door opening at both sides and separate freezer compartment
- + Coffee machine lift, can be lowered out of overhead storage compartment
- + Bar cupboard with decorative glass door and interior lighting
- + Room-high slide-out storage cabinet



Large lengthways single beds

- + Adjustable head sections
- + Wardrobe beneath the lengthways single beds, easily accessible from the front and above via the lift function – lowered into the double floor for additional volume
- + Sleeping area extension between the beds using additional mattress, access via pull-out comfort access steps
- + Standard TV cabinet, optional extra long TV pull-out system



Space saving combined washroom with changing room

- + Separate round shower
- + Integrated shelf in shower wall
- + Towel holder in rooflight
- + Large mirror cabinet with shelving
- + Solid washroom door with strong hinges, metal handle and door lock

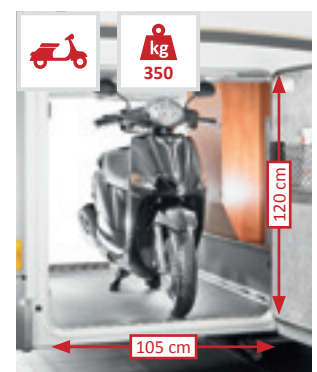

Chassis	Weight ready to drive	Payload up to	Seats with three-point seat belt	Berths
Fiat Ducato AL-KO Low frame 35 light	3,165 kg	1,295 kg	4/5*	2/3-4*

*with options



Corner kitchen with professional gourmet cooker in linea classica world of style



Room-high wardrobe



Combined washroom

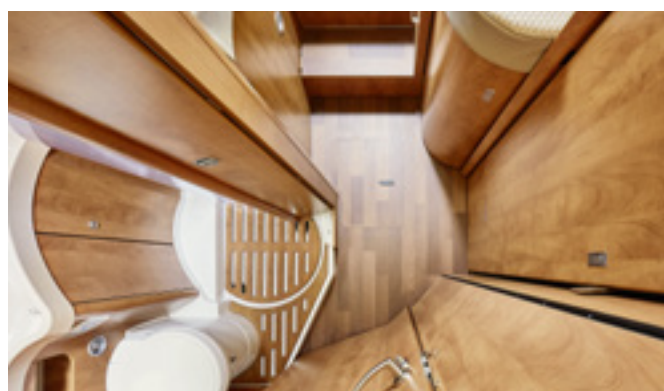

Combined washroom with changing room function



Large lengthways single beds with pull-out comfort access steps

chic c-line

chic c-line T 4.9 LE



Registered for patent approval.⁽¹⁾
Leading by means of innovation.

Double function door washroom / toilet room;
Pull-out comfort access steps

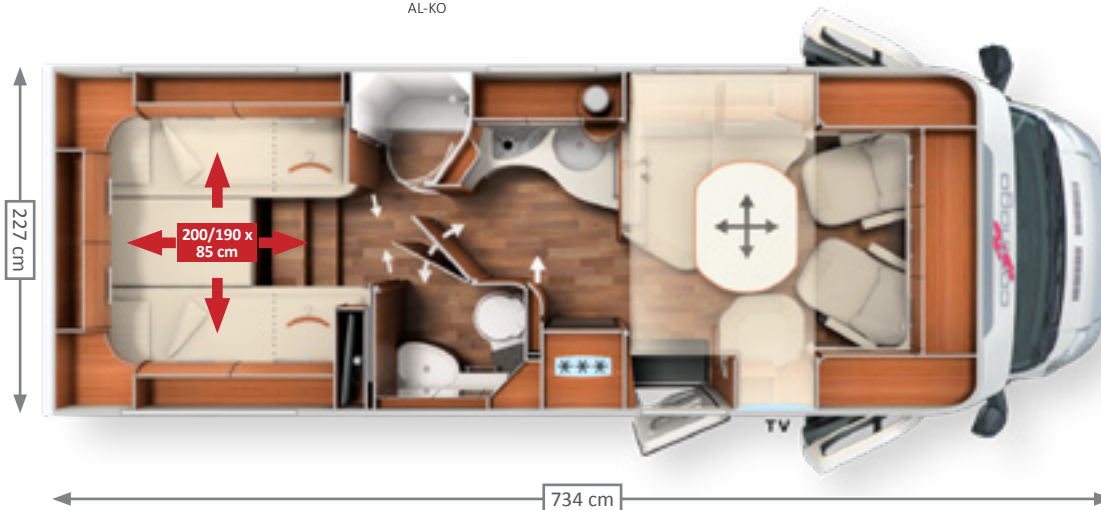

Large L-shaped lounge seating group with wide side seat bench

- + Rectangular living room table with chrome piping, optional 5th belted seat
- + Pull out system for 24" LED flat screen behind side seat bench back rest



+ Lengthways single beds

- + Adjustable head sections
- + Wardrobes beneath the lengthways single beds, easily accessible from front and above thanks to lift function – lowered into the double floor for additional interior height
- + Sleeping area extension between the beds using additional mattress, access via pull-out comfort access steps
- + Standard TV cabinet, optional extra long TV pull-out system



Luxury corner kitchen

- + Large, curved work surface
- + Kitchen area with six large drawers, centre drawer with integrated waste bins
- + "Professional gourmet" 3-ring hob with 2 part glass cover, robust cast iron trivet and easy-clean glass surface
- + 153 l fridge with door opening at both sides and separate freezer compartment
- + Coffee machine lift, can be lowered out of overhead storage compartment
- + Bar cupboard with decorative glass door and interior lighting
- + Slide-out storage cabinet integrated in round wash-room wall



Comfort luxury washroom with changing room

- + Large washroom/toilet room
- + Shower opposite
- + Solid wooden sliding door with room dividing function, separating the changing room from the sleeping area and the living area

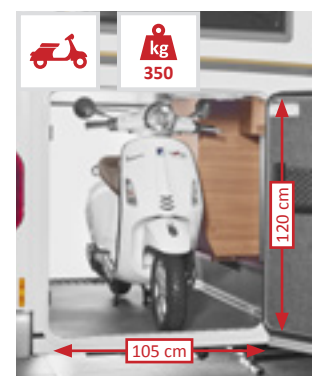

Chassis	Weight ready to drive	Payload up to	Seats with three-point seat belt	Berths
Fiat Ducato AL-KO Low frame 35 light	3,165 kg	1,295 kg	4/5*	2/3-4*

*with options



chic c-line T 4.9 LE in linea moderna world of style, part-leather ivory world of living with optional "skyview" skylight



TV pull-out system behind backrest



Luxury corner kitchen with curved work surface in linea moderna World of Style



Wardrobes beneath the lengthways single beds with extra-large interior height



Luxury washroom with separate shower



Lengthways single beds with wardrobes beneath

chic c-line

chic c-line T 5.0 QB



Registered for patent approval. ⁽¹⁾
Leading by means of innovation.

Double function door washroom / toilet room;
Pedelec garage;
pull-out room divider and television wall

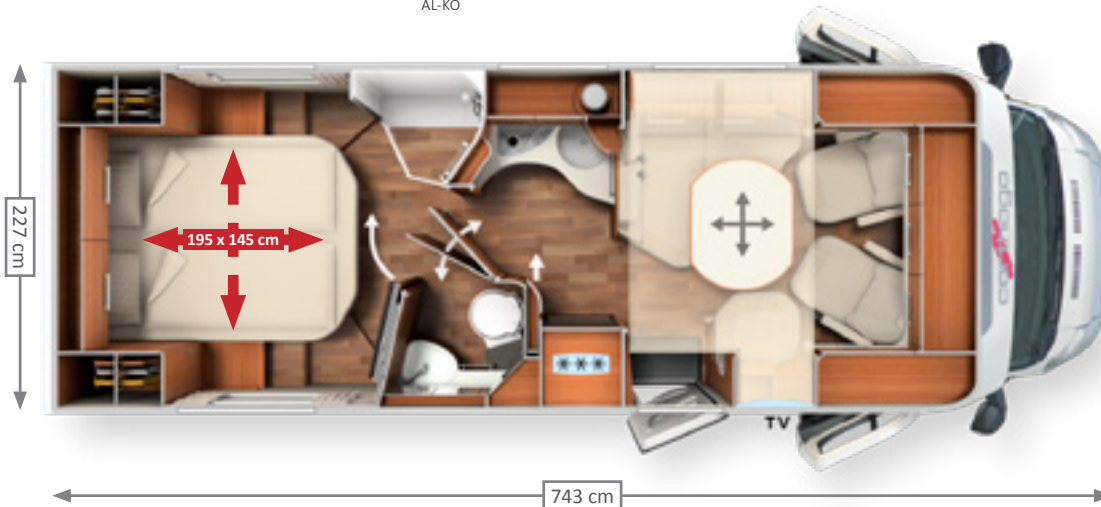

Large L-shaped lounge seating group with wide side seat bench

- + Rectangular living room table with chrome piping, optional 5th belted seat
- + Pull out system for 24" LED flat screen behind side seat bench back rest



Luxury corner kitchen

- + Large, curved work surface
- + Kitchen area with six large drawers, centre drawer with integrated waste bins
- + "Professional gourmet" 3-ring hob with 2 part glass cover, robust cast iron trivet and easy-clean glass surface
- + 153 l fridge with door opening at both sides and separate freezer compartment
- + Coffee machine lift, can be lowered out of overhead storage compartment
- + Bar cupboard with decorative glass door and interior lighting
- + Slide-out storage cabinet integrated in round washroom wall



Comfort luxury washroom with changing room

- + Large washroom/toilet room
- + Shower opposite
- + Washroom/toilet room double function door for simultaneous separation of living room passage and toilet room



Large queen-size bed

- + Unique: pull-out room partitioning and TV wall for separating washroom area with TV holder, wireless TV enjoyment in two positions possible
- + Adjustable head section
- + Two wardrobes at each side of the queen-size bed
- + Two drawers at the front of the queen-size bed

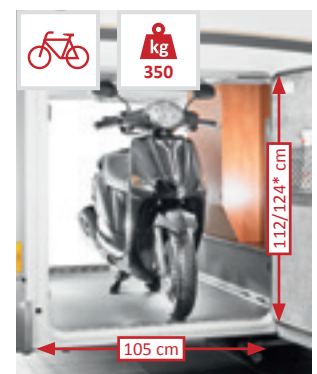

Chassis	Weight ready to drive	Payload up to	Seats with three-point seat belt	Berths
Fiat Ducato AL-KO Low frame 35 light	3,165 kg	1,295 kg	4/5*	2/3-4*

*with options



Coffee machine lift, can be lowered out of overhead storage compartment



TV pull-out system behind backrest

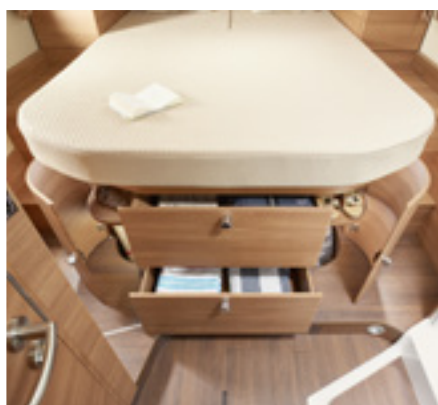

Two drawers at front of queen-size bed



Luxury corner kitchen with curved work surface in linea moderna World of Style



Comfort luxury washroom with changing room



Extendible TV wall in TV centre position

chic c-line

Exterior



AL-KO

Standard white

Main cabin white, vehicle front white, A-pillar, front, side, rear skirt and wheel arches silver-platinum



Optional Silverline

Main cabin silver, drivers cabin silver, front, side, rear skirt and wheel arches silver platinum



Fiat Ducato front design (Silverline)



Fiat Ducato rear design (Silverline)

Interior

chic c-line on Fiat Ducato with part leather ivory world of living



chic c-line T

Optional: unique Carthago Pedelec garage

for queen-size bed models - interior height extension to 124 cm. Registered for patent approval.⁽¹⁾

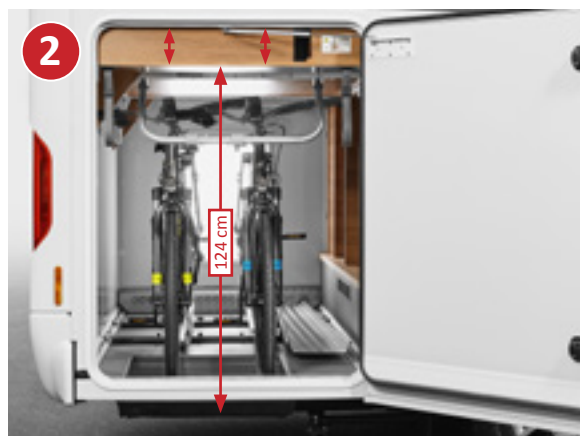

Your added value with Carthago

- + Interior height extension of the Pedelec garage up to 124 cm in queen-size bed models
- + Despite having a low bed access height, a bicycle up to 124 cm in height can be transported in the rear garage
- + Innovative solution with no additional weight and simple operation
- + Cover plate for floor recess, can also be used with a level garage floor



Usable height
up to 70 cm

Double floor with huge storage compartment

EASY ENTRY – convenient loading from the outside,
easy removal from the inside



PASSENGER SIDE

Gas bottle compartment



Scooter garage with considerable interior height thanks to deep lowering, accessible at both sides via a large door at the driver's side and a second door at the passenger side

Exterior loading



Convenient loading of the double floor storage compartment via a large external hatch (at the passenger side)

Unload from the inside



Easy removal of storage compartment contents from the inside via the swing-up seat bench cover of the L-shaped lounge seating group

Further double floor storage



Living area floor hatch with double floor storage box (42 cm usable depth) in heated double floor

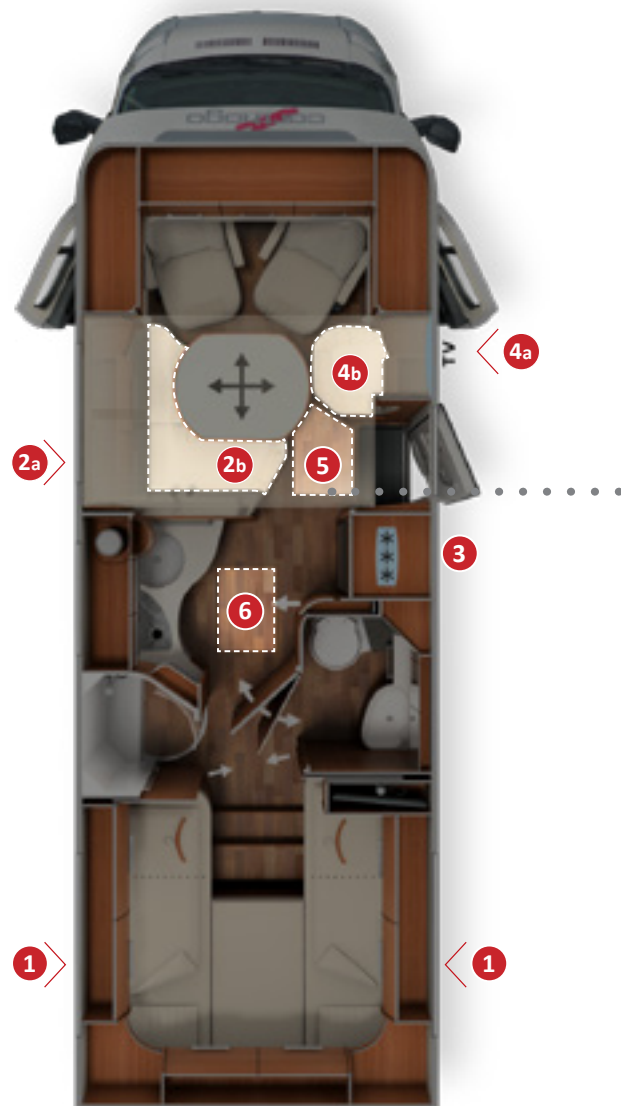



- + **Double floor** with huge, heated storage compartment, usable height up to 70 cm
- + **Exterior access** via several large hatches
- + Convenient **interior access** via the L-shaped lounge seating group seat bench cover, hinged side seat bench and the large living area floor hatch
- + **Large, central through-loading space** (interior height 22 cm), with extra-low double floor storage compartment (usable height 46 cm), convenient loading through the entrance door via a large, adjustable living area floor hatch
- + The entire double floor is heated with a **climate storage function** and underfloor heating effect



DRIVER'S SIDE



Large, additional double floor storage compartment with separate exterior hatch (at the driver's side)



Convenient loading of the double floor storage compartment via a large external hatch

Exterior loading



Huge living area floor hatch in the entrance area: easy to load from the outside when main cabin door is open



Convenient removal of contents via the hinged side seat bench

Unload from the inside



On-board technology

Electrical technology, water supply, warm air storage heating technology



Hot air storage

heating system Truma Combi 6



Optional: ALDE warm water central heating



Double floor

With climate storage function and underfloor heating effect



Capacity

170 l fresh water tank
140 l waste water tank
2 x 80 Ah gel battery



Targeted heating of driver's cab area thanks to heated dashboard front and additional warm air outlets



Truma Combi 6 Heat storage heating system Truma Combi 6 with warm air outlets in the entire climate storage double floor, in the living area, in the rear garage, in the driver's cabin and in the door entrances



"easy change" gas bottle compartment, extra-low for convenient bottle changing



Heated battery centre with main battery switch; Standard: Gel batteries 2 x 80 Ah, optional Lithium ion battery 90 Ah including battery computer



Electrical centre easily accessible in rear garage

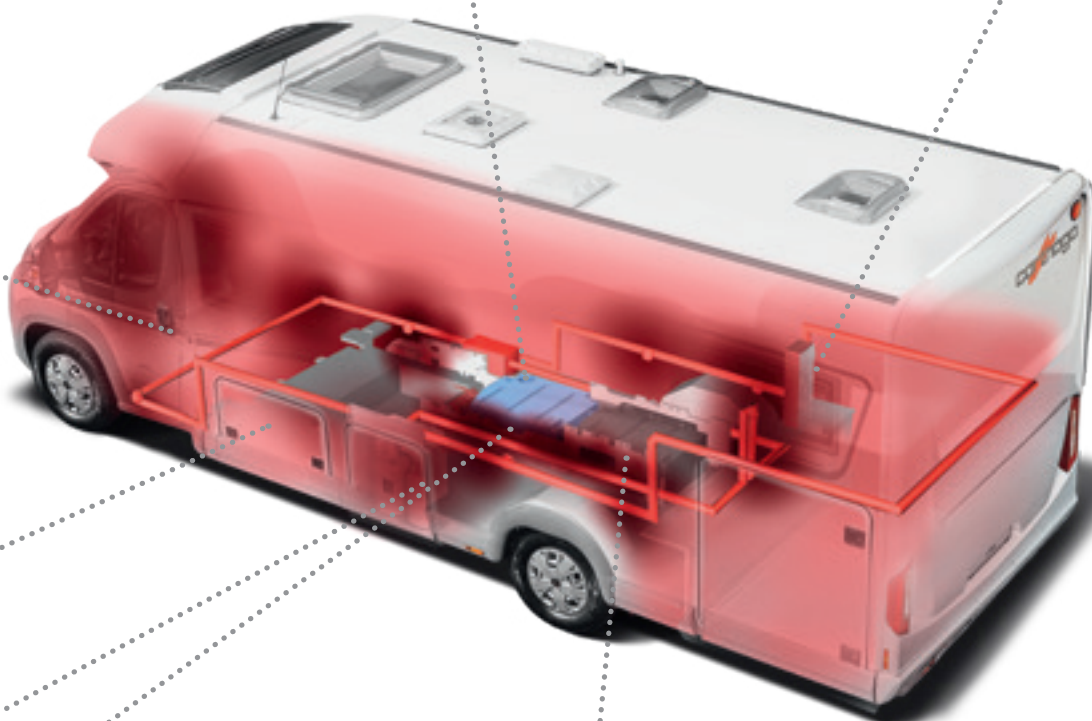

Water tanks protected from frost in heated double floor



Central water drain in the double floor – can also be operated from the outside through the main cabin door

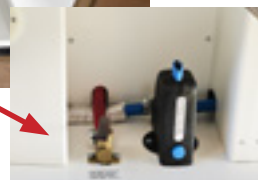

“Coming Home” function



with central locking: driver's cabin doors via remote control in main key, exterior light activation

Main cabin door “premium two”



with safety double locking system, door limiter, door window and insect screen blind

Driver's cabin pilot seats



with armrests on both sides, adjustable in several directions, headroom in living mode at lounge seating group level

Single level living area floor

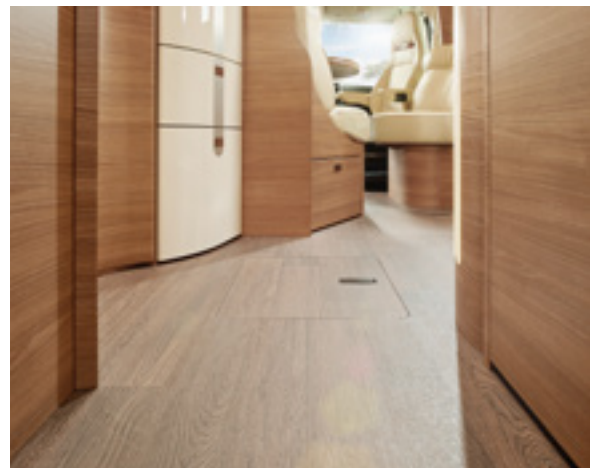

continuous from driver's cabin to the sleeping area

Driver's cabin storage space



thanks to all-round overhead storage cabinets with front flaps

Shoe cabinet



in the seating group in the entrance area with shoe storage system for up to four pairs of shoes

Ambient lighting



with infinitely variable dimming function (mood light)

Living area table



movable in two directions and rotates 360° for optimal integration of all seats

Professional gourmet cooker



with 3 hobs, easy-clean glass top, iron grate and split glass cover

Slide-out storage cabinet



practical storage space with easy access at hand height (T 4.8 LE room height)

Coffee machine lift



can be lowered from the kitchen overhead storage compartment (lift standard, coffee machine or capsule coffee maker optional)

Carawinx sleeping system



medically recommended, point elastic under springing system and 7-zone quality cold foam mattress

Worlds of Living

Large selection – the new upholstery collections from Carthago

	Collection	c-tourer		chic c-line	
	World of Style	epic bicolor	Casablanca	linea classica	linea moderna
Fabric	Barcelona 21	●	●	●	●
	Venezia 21	●	●	●	●
	Cambridge	●	●	–	–
	Rome	●	●	–	–
Textile leather fabric	Malaga 21	○	○	○	○
	Davos	○	○	○	○
	San Remo	○	○	○	○
	Stockholm	○	○	○	○
Textile leather	Ivory part leather 21	○	○	○	○
	Macchiato part leather 21	○	○	○	○
	Ivory Supreme part leather	–	–	○	○
	Sand Supreme part leather	–	–	○	○
Leather	Ivory leather 21	○	○	○	○
	Sand leather 21	○	–	○	○
	Macchiato leather 21	○	○	○	○
	Sand Performance leather 21	–	–	○	○
	Macchiato Performance leather 21	–	–	○	○

● Standard equipment ○ optionally available – Not available depending on model

Your added value with Carthago

- + **Highly effective stain protection**
Fluids do not penetrate into the fabrics.
The majority of stains can be easily wiped off with a damp cloth.
- + **Excellent anti-fade properties**
- + **Hard-wearing and easy to look after**
- + **Washable curtains and decorative pillow covers**
- + **Antibacterial mattress cover**



Highly effective stain protection systems protect your upholstery

Upholstery design

c-tourer semi-integrated



The seating groups of the c-tourer T model series emanate sporty lightness with their dynamic contrasting inserts. This is emphasised by the modern double-stitched seams, which underline our high quality feel. These double-stitched seams are in a contrasting colour in the “Sand leather 21” and “Macchiato leather 21” collections. In the “Malaga 21” collection, elegant contrasts are provided by additional piping. Please pay attention to the design differences between the T 145 LE H and T 148 LE H models: piping or high-quality double-stitched seams are used as style elements at the edges of the upholstery. In the “Sand leather 21” and “Macchiato leather 21” collections, these double-stitched seams are in a contrasting colour and combined with piping in the same colour. In the “Malaga 21” collection, contrast is provided by piping and an additional stripe.

chic c-line semi-integrated



The seating groups of the chic c-line T model series create an elegant living room atmosphere. Piping or high-quality double-stitched seams are used as style elements at the edges of the upholstery. In the “Sand leather 21” and “Macchiato leather 21” collections, these double-stitched seams are in a contrasting colour and combined with piping in the same colour. In the “Malaga 21” collection, contrast is provided by piping and an additional stripe. Our “Part leather supreme” collections combine the most sophisticated materials from well-known Hitex® manufacturer “Rohleder” with fine leather. For high-end premium leather options in our vehicles, we have the “Performance” collections, which impress in the manufacturing style with their elaborately quilted leather inserts.

Worlds of Living*

Very high quality Antara / fabric combination:

Antara with highly effective “Teflon Repel” stain protection, contrasting fabric with dirt-repellent stain resistance

Barcelona 21

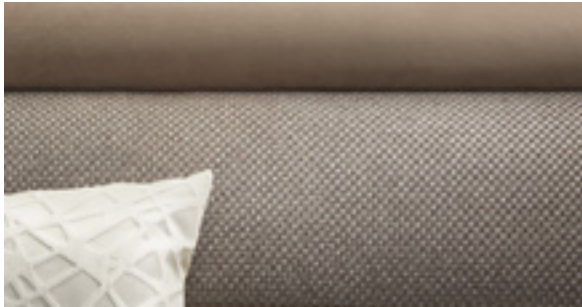

Venezia 21



Cambridge

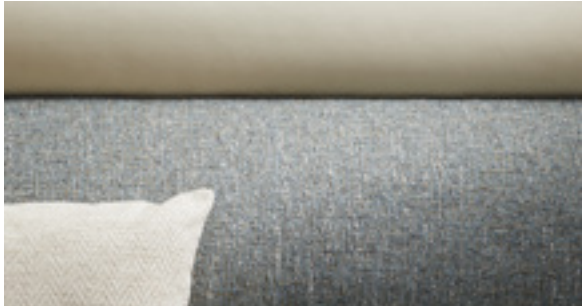

Rom



Very high quality textile leather / fabric combination:

extremely hard-wearing textile leather in soft Nappa quality, contrasting fabric with dirt-repellent stain resistance

Malaga 21



Davos

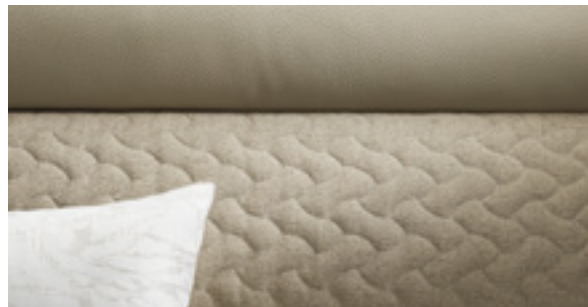

San Remo

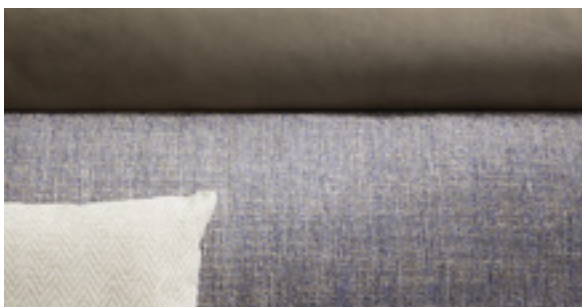

Stockholm

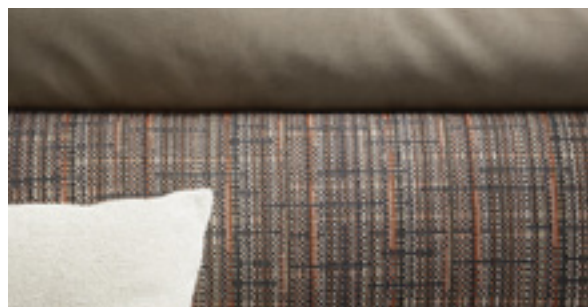

Very high quality leather / fabric combination:

leather with outstanding quality, contrasting fabric with dirt-repellent stain protection

Ivory part leather



Macchiato part leather

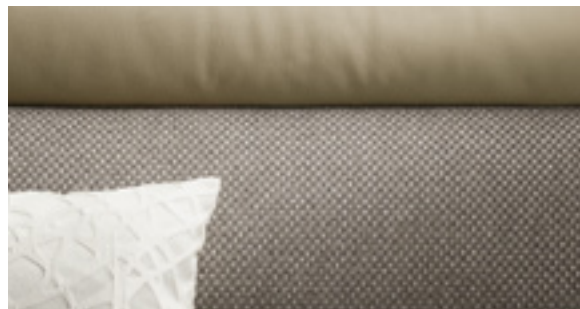

Ivory Supreme part leather

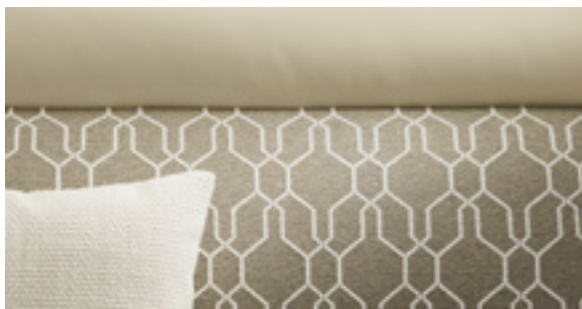

ROHLEDER
DIE HITEX MANUFATUR

Sand Supreme part leather

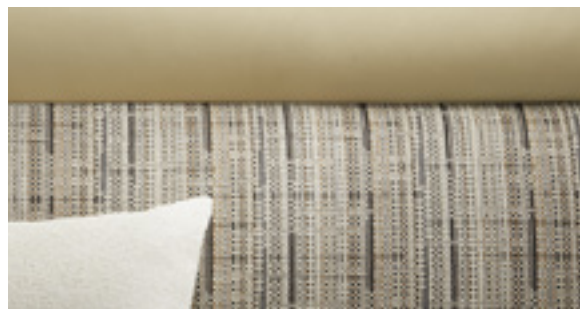

ROHLEDER
DIE HITEX MANUFATUR

Very high quality leather finish:

classy combination of leather with outstanding quality

Ivory leather 21



Sand leather 21

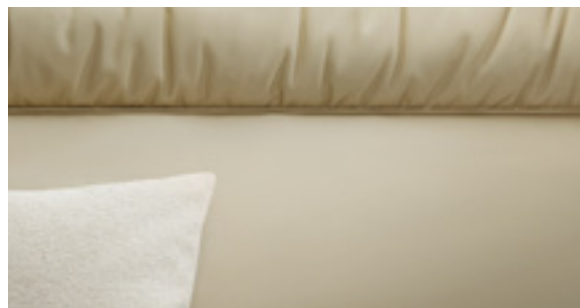

Macchiato leather 21



Sand Performance leather 21

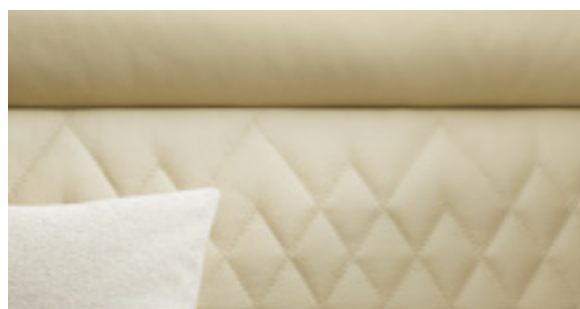

Macchiato Performance leather 21

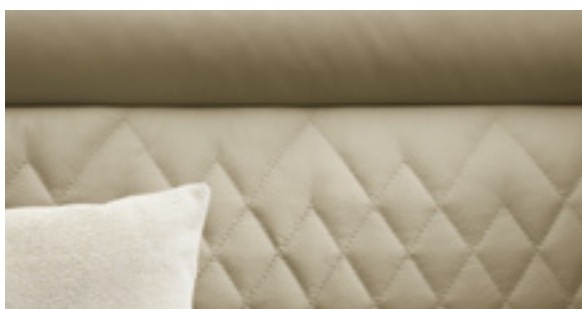

The Carthago Premium DNA

More than a good feeling

Innovative thinking, an eye for detail, extravagant solutions and consistent development focus on a high degree of practical use, the perfect combination of high-tech lightweight construction materials, intelligent processing and pioneering spirit: these are the ingredients for our unique overall vehicle concept.

They are deeply rooted in our **Carthago Premium DNA**. It is an incentive and an obligation at the same time: the Carthago Premium DNA is our value promise to each Carthago customer, and brings together that which characterises every one of our motorhomes. And at the same time, it expresses what makes Carthago different from other motorhomes. Our core expertise is in motorhomes

in the liner premium class. This because our **40 years of experience** in this industry flow into every stage of development and manufacturing. We think that only the best is good enough for your comfort and your safety! The materials and construction technologies that we use and the demands that are made of their weight and stability have many similarities to aviation technology.

In this way we can offer you a high degree of durability and value retention, safety, protection and comfort. In this way, each Carthago motorhome becomes something special, and therefore a **synonym for exclusivity and quality**. Or, to put it simply, Carthago stands for "The Motorhome".

Long-lasting. High stability.

**Carthago Liner
premium-class
body construction**

Space guaranteed.

**Carthago double floor
with huge storage
compartment**

Well-balanced. Optimum
distribution.

**Carthago payload &
weight and balance**



Well-being – all year round.

Carthago heating & air conditioning technology

Unique. Unmistakable.
Extravagant.

Carthago Personality

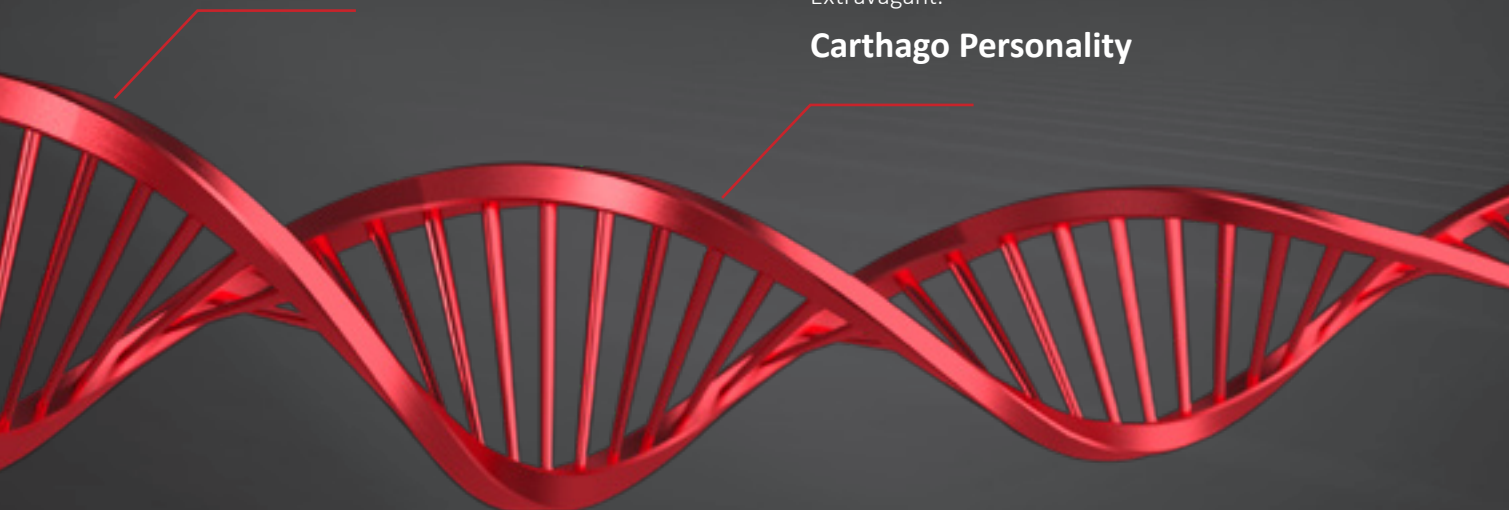

Liner premium-class body construction

Longevity, protection and value retention

The Carthago body construction consistently orientates itself to what Carthago drivers desire: long-term carefree driving and value retention. We therefore rely on **long term quality**. GRP and aluminium are used where they are most effective. For your protection and comfort, even in

the event of hail, moisture, lightning and cold conditions. The unique chassis connection via **extremely stable frame members** is the guarantee of maximum torsional rigidity. Quality that you can feel – journey after journey, year after year.

Your added value with Carthago

- + Protection against lightning strikes, hail and moisture
- + 10-year warranty against leaks
- + Easy to repair in the event of damage
- + Stone chipping and underfloor protection

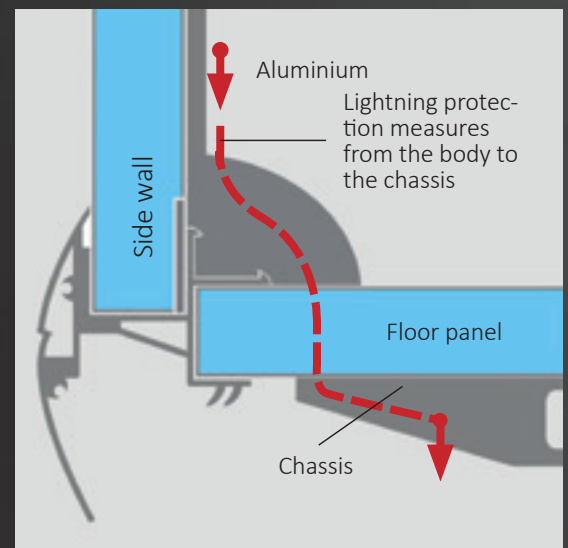

Tested lightning protection

Aluminium on the roof and the inner walls provides protection like a Faraday cage. Additional lightning conductors in the chassis significantly increase this protection effect. The lightning protection test has been proven: a Carthago main cabin provides verified protection against lightning strikes!



Lightning penetration with conventional GRP roof with wood/GRP roof interior.



**10-year warranty
against leaks!**



Hail protection

and cheaper insurance premiums thanks to the GRP roof top. The special feature: the protection against lightning strikes is retained thanks to the aluminium on the inside of the roof.



Moisture protection

thanks to top side of roof made from GRP.



**Tested lightning
protection**

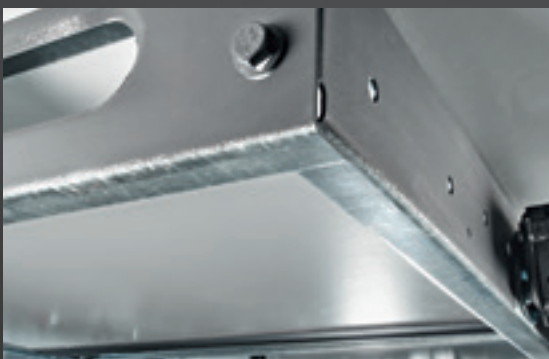

Stone chipping protection / lower floor guard

The GRP underfloor provides long-term protection from stone chipping, rotting and moisture damage. For years – without the need for maintenance! The lowered frame of the scooter garage simultaneously acts as a lower floor guard and reduces collision damage.



Ease of repair

Wherever possible, attention is paid to segmentation during the development of the main body components. This makes replacement easier in the event of damage and reduces costs. For example, there is a separately replaceable rear bumper at the rear of every vehicle.

Liner premium-class body construction

Advanced technology inspired by aircraft construction

Carthago bodies have strong and durable connections. Where others use screw connections, we apply high-tech. As well as a high degree of stability, a main body reinforced with **frame members** and **special bonding technologies** also provides a clear advantage with regard to safety.

The frame member for connecting the floor and the side walls acts as side collision protection if the worst comes to the worst. Thanks to features inspired by aircraft construction, the main cabin is not only highly stable, but also light and torsionally rigid.

Your added value with Carthago

- + **Durability and value retention**
for many years
- + **Perfect insulation and heat storage**
for year-round comfort
- + **Maximum body stability**
and torsional rigidity, the decisive contribution to ride comfort and driving safety
- + **Light vehicle weight**
due to self-supporting body design
- + **100 percent wood-free body,**
no rotting possible – also over the long term

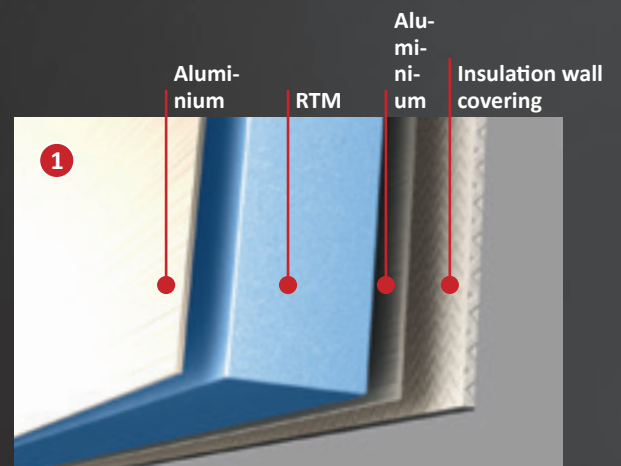

Carthago side wall construction

Having aluminium not just on the exterior but also the interior of the walls is a prerequisite for efficient heat storage. This produces the typical Carthago well-being climate. The homogeneous heat radiation acts like a wall heater.

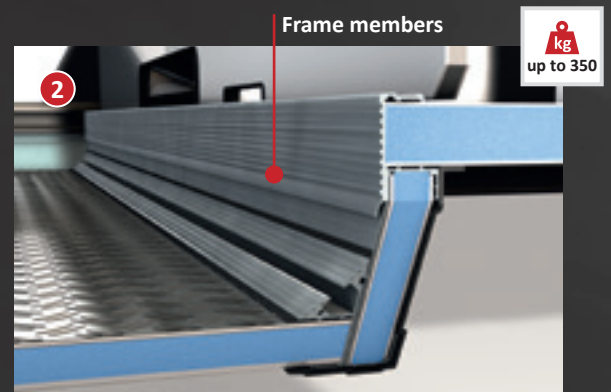

Carthago lower-level scooter garage

Deep lowering of the scooter garage means maximum storage space and minimal effort when loading. Extremely strong wall to floor connection due to form-fitted and bonded frame members makes loading of up to 350 kg possible.

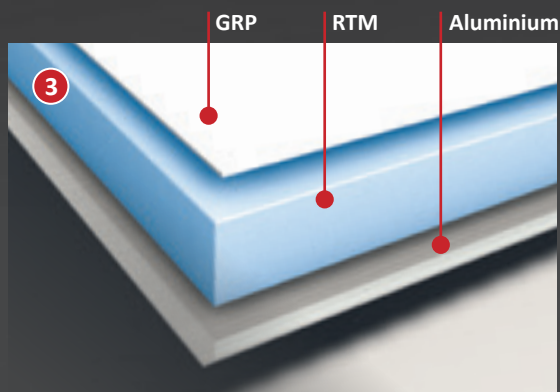

Carthago roof structure

Having GRP on the exterior means protection from hail, and having aluminium on the interior means protection against lightning strikes. The aluminium interior also takes over the function of heat storage in winter.

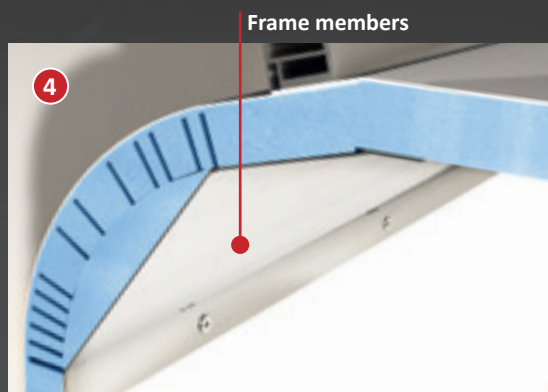

Carthago roof - wall joint

The typical Carthago curved roof is not only an unmistakeable design element but with the frame members on the inside, it makes a decisive contribution to the rigidity of the main cabin. And all of this without any thermal bridges whatsoever. Another safety bonus: less sensitivity to side wind.



**Body connection
with high-stability
frame members**

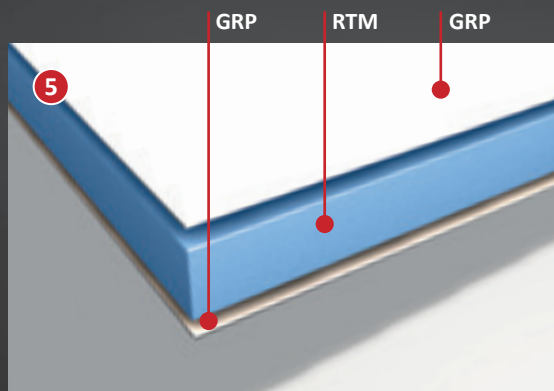

Carthago floor panel

Provides all-round protection. The lower and upper sides are made from GRP, and between them there is a hard foam insulating core made from RTM Styrofoam. The high-stability floor plate has a lifelong protection against humidity and rotting.

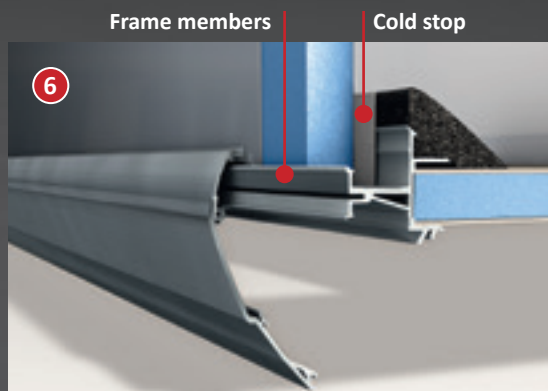

Carthago floor - wall joint

Used on both sides via a high-stability frame member. As in aircraft construction, it is form-fitted and bonded along the entire length. And if the worst comes to the worst, it has the effect of side collision protection. An integrated thermal bridge stop reliably prevents any thermal bridges.

Double floor with huge storage compartment

More room for your holiday

You can never have enough storage space in a motorhome! The Carthago semi-integrated motorhomes provide a huge amount of storage space and room for your entire holiday luggage due to the unique double floor and many easily accessible storage compartments.

Bulky luggage such as camping furniture and skis can be stowed away in an optimum way in the central through-loading storage compartment. The double floor can easily be loaded from the outside via numerous large exterior hatches.

Large self-supporting living area floor hatches provide access to the extra-deep storage compartments in the living and kitchen areas.

The double floor also acts as insulation, protecting your cargo from frost.

Your added value with Carthago

- + **Most storage space in its class**
- + **Unique, huge double floor**
- + **Convenient exterior and interior access "EASY ENTRY"**
load from the outside, unload from the inside
- + **Extra-deep storage compartments for additional usable height**
- + **Lowered storage compartment elaborately manufactured in original bodywork sandwich**, therefore maximum stability and high-efficiency insulation
- + **Fully usable storage compartment volume**, no restrictions due to installation of technical components
- + **Weight and balance - weight optimisation** and additional payload thanks to maximum usable axle loads and balanced weight distribution between front and rear axle





Double floor with huge storage compartment

EASY ENTRY – convenient loading from the outside, easy removal from the inside



Usable height
up to 70 cm



PASSENGER SIDE

Gas bottle compartment



Rear garage
can be loaded
up to
350 kg

Scooter garage with considerable interior height thanks to deep lowering, accessible at both sides via a large door at the driver's side and a second door at the passenger side

Exterior loading



Convenient loading of the double floor storage compartment via a large external hatch

Unload from the inside



Easy removal of storage compartment contents from the inside via the swing-up seat bench cover of the L-shaped lounge seating group

Other double floor storage compartments



Living area floor hatch with double floor storage box (42 cm usable depth) in heated double floor

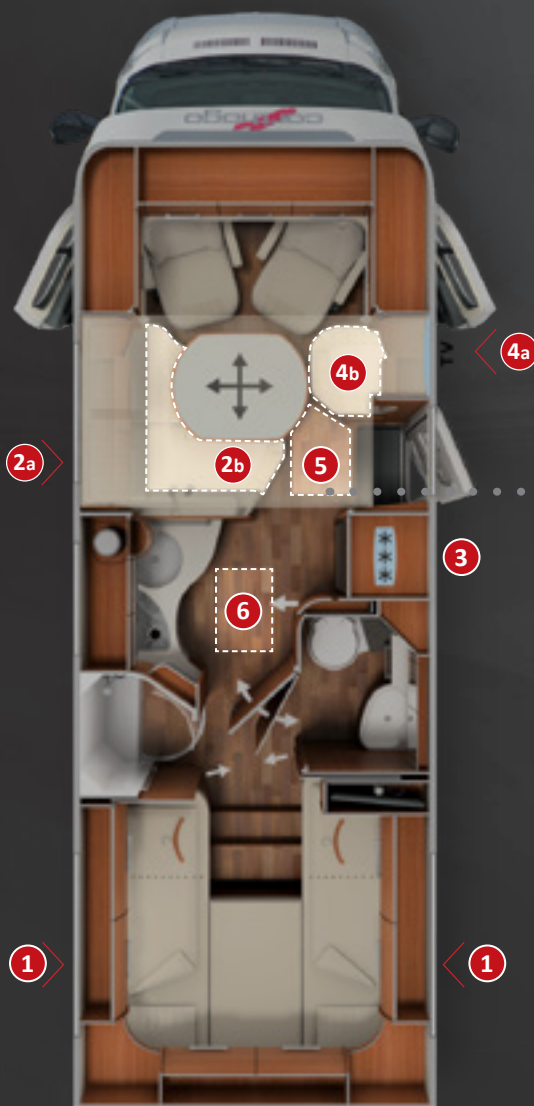

- + **Double floor** with huge, heated storage compartment, usable height up to 70 cm
- + **Exterior access** via several large hatches
- + **Convenient interior access** via the L-shaped lounge seating group seat bench cover, the swing-up side seat bench and the large living area floor hatch
- + **Large, central through-loading space** (interior height 22 cm), with extra-low double floor storage compartment (usable height 46 cm), convenient loading through the entrance door via a large, adjustable living area floor hatch
- + The entire double floor is heated with a **climate storage function** and underfloor heating effect



DRIVER'S SIDE



Large, additional double floor storage compartment with separate exterior hatch



Convenient loading of the double floor storage compartment via a large external hatch

Exterior loading



Huge living area floor hatch in the entrance area: easy to load from the outside when main cabin door is open.



Convenient removal of contents via the hinged side seat bench

Unload from the inside



Carthago Pedelec Garage

The garage wonder for queen-size bed models with an interior height extension of up to 124 cm

Will your big bike or Pedelec not fit into the rear garage of your motorhome?

Not a problem with Carthago's queen-size bed models. This is how it's done: just swivel up the rear bed from the outside **with a single manual operation**, park the bike in the garage, **lower the rear bed again**. The Carthago trick: a recess in the floor accommodates the bike.

Securely lash everything – done in an instant and handlebar heights of up to 124 cm are possible in combination with the swing-up bottom edge of the bed. In spite of this, the bed is easily accessible from the inside at any time thanks to the low position. Just another one of the many great Carthago ideas. And because it's so good, we've **registered it for patent**.

Your added value with Carthago

- + **Interior height extension**
of the Pedelec garage to up to 124 cm in the queen-size bed models
- + **In spite of low bed access**
Bike with handlebar height of up to 124 cm can be transported in the rear garage, no unloading required in order to sleep
- + **Innovative solution**
with no additional weight and simple operation
- + **Cover for the recess in the floor**
can therefore also be used as an additional storage compartment with a level garage floor



Easy loading
of a Pedelec using the hook-on drive-in ramp



Loading height extension
by simply swinging up the interior rear bed with one hand and the additional sunken floor recess (making a handlebar height of up to 124 cm possible)



Registered for patent approval⁽¹⁾: Carthago Pedelec garage - leading by means of innovation

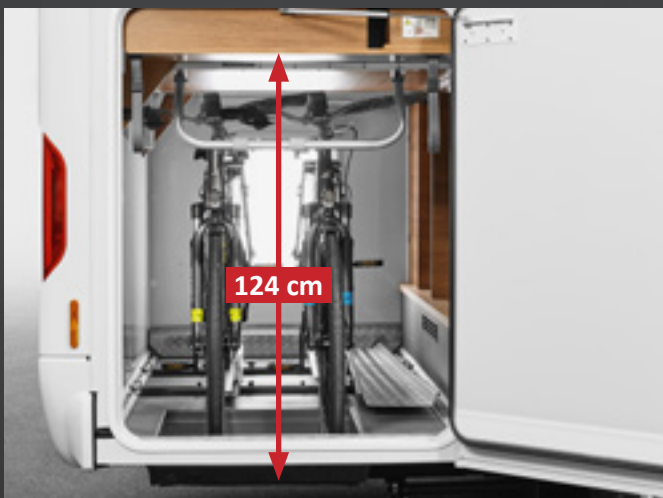

Pedelec garage
c-tourer and chic c-line (depending on model)

Carthago payload & weight and balance

Travel in comfort and safety with a heavy payload

No fear of the scales: a Carthago has reserves, even for large luggage items! You will find a large payload in the construction specification of every new Carthago. Because it represents the basis of a high degree of comfort and safety on your travels. It is a natural constituent of the Carthago Premium DNA. A harmonious weight balance is a matter of course for a Carthago. Two or even three-axle load-bearing chassis represent the basis. Clever wheelbases ensure that the weight distribution is favourable, utilise the maximum axle loads and lead to a safe and confident driving style at the same time. Intelligent

lightweight construction technology reduces the weight of the vehicle. Finally, the numerous gross vehicle weight variants ensure that you have exactly the payload that is individually required. Carthago also means not having to forego anything with regard to payload, since holidaymakers do not have to restrict themselves, even on long trips: you can simply take your favourite things from clothing to Pedelecs with you in the generous storage compartments. And a Carthago also always has sufficient reserves for taking souvenirs from the vineyard or the fashion store home from your holiday.

Your added value with Carthago

- + **Maximum travel comfort,**
no restrictions as far as luggage is concerned, and optimum utilisation of the potentially record-breaking storage compartments in the Carthago motorhome
- + **Weight and balance - weight optimisation**
Additional payload due to balanced weight distribution between front and rear axle
- + **Numerous individual weight variants**
result in individual reserves for each model and each configuration
- + **Maximum safety on the road**
No risk due to overloading and over-stressed components, safe driving style

PRESS OPINIONS

"Carthago constructs its vehicles in a way that is very suitable for winter. This is why the c-tourer also has a double floor. This results in an additional, heated storage compartment with through-loading, as well as a single level living area floor."

Camping Revue, 02/2019,

Technical test of c-tourer T 145 DB H

"With the chic c-line T 4.9, Carthago is showing that the semi-integrated is also good for mobile luxury, as well as for the entry level and middle classes. Heated double floor, large garage and plentiful amount of room are standard in this vehicle. The vehicle design is stylistically unique at Carthago."

Reisemobil International, 09/2017,

Comparison test of chic c-line T 4.9 LE



Maximum payload reserves – balanced out in the best possible way.

On the example of the c-tourer T 143 LE

Payload reserves per axle depending on the vehicle configuration



The Carthago double floor

Together with the high-stability self-supporting main body construction, it contributes to providing a high degree of stability and torsional rigidity, and is extremely lightweight at the same time. A "special light" AL-KO low frame is used exclusively for the lightweight models. Result: minimal vehicle weight – maximum payload.



Balanced weight distribution

Large storage compartments and sufficient payload alone are not enough. Carthago uses wheelbases which are coordinated in a model-specific way. The result is an optimum weight balance between the front and rear axle – the prerequisite for practical use of the storage space.

Carthago heating and air conditioning technology

Cosy and comfortable, just like at home

We can't think of any reason why you should have to forego a good climate, regardless of where you are travelling to, and when. For this reason, a Carthago provides year-round comfort thanks to technical refinements such as heat-reflecting walls, targeted heating of on-

board equipment and heat circulation throughout the double floor. This provides the best conditions for a **real well-being climate during both summer and winter**. Because that which insulates and keeps the heat in during the winter also keeps you cool during the summer.

Your added value with Carthago

- + **Winter-proof motorhome**
with year-round comfort
- + **Underfloor heating effect**
your feet are always warm
- + **No cold air draughts**
thanks to cold stop at critical points
- + **Even heat distribution**
and radiation due to the aluminium inner wall
- + **Heat storage effect**
and efficient insulation reduce gas consumption
- + **Targeted heating**
of all technology components safeguards functionality



Targeted heating of the driver's cab

In all semi-integrated models, the front area of the dashboard has targeted heating.

As a result, the double-shell front end acts like an area heater. The living area in the driver's cab therefore has a pleasant temperature without a flow of cold air coming from the vicinity of the windscreen.



Carthago underfloor heating effect

Numerous hot air outlets and heat circulation channels in the double floor ensure that the heat is evenly distributed. This heat accumulation radiates upwards towards the floor of the living area and gives it a pleasant warmth. You'll always have warm feet in a Carthago.





Aluminium interior walls
= 1,000 times better heat
distribution than traditional
wooden interior walls

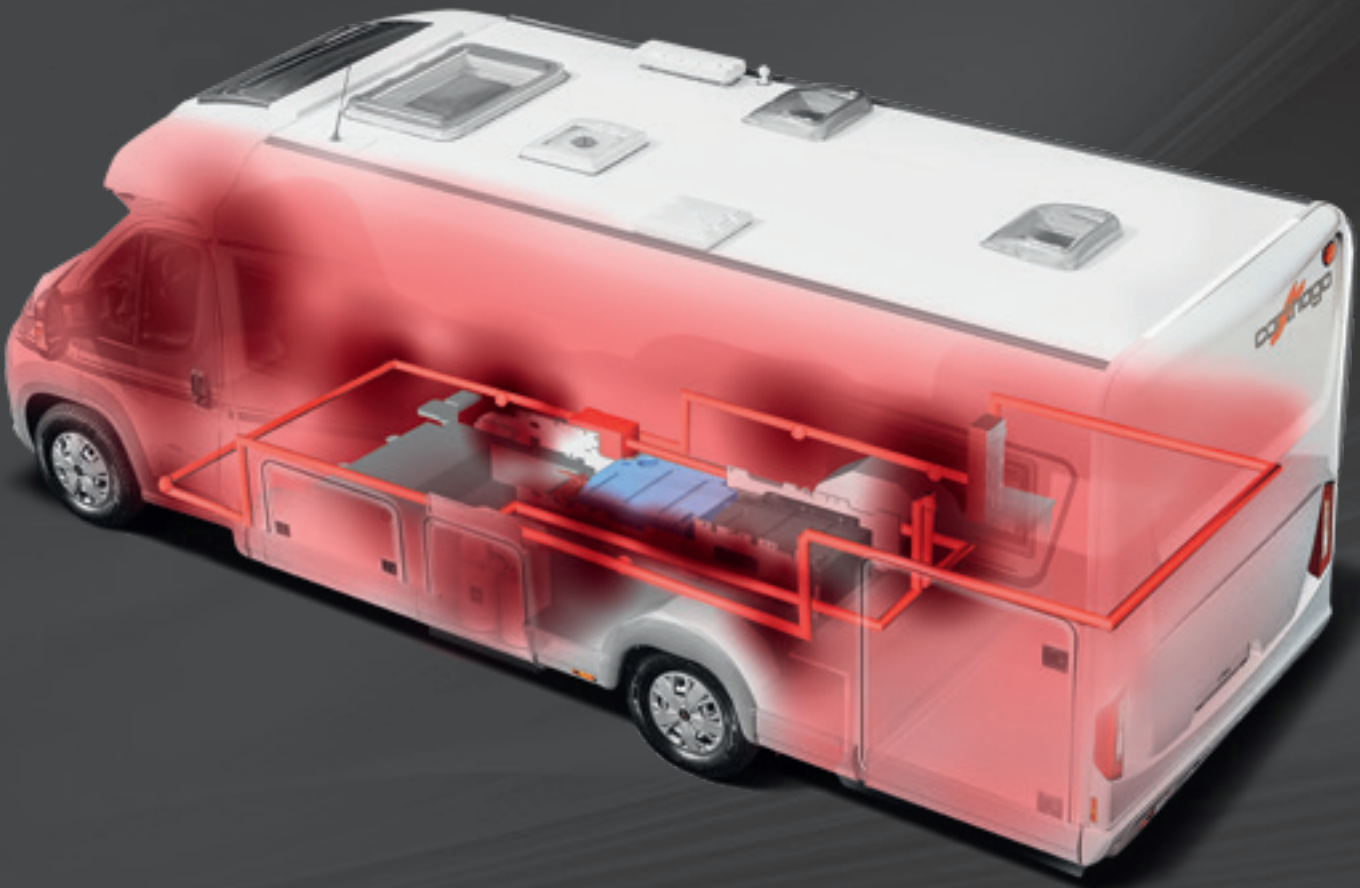

Heated technical components

The fact that a motorhome has a heater is standard. So is the fact that it heats the living area. Areas which are sensitive to cold are provided with targeted heating in a Carthago motorhome: all technical components such as tanks, batteries, storage compartments, doorways, etc. This is the guarantee of full functionality, even at low minus temperatures.

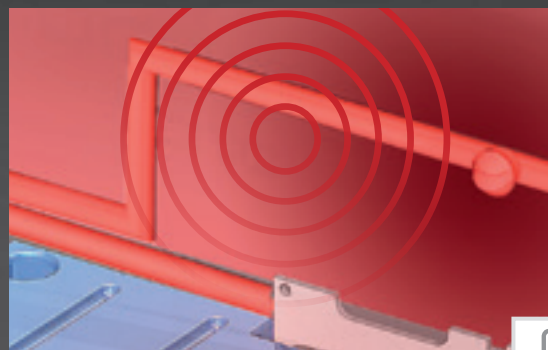

Carthago wall heater effect

Aluminium that is also on the insides of the walls stores the heat that is absorbed and evenly gives it off it again. This results in a very pleasant wall heater effect. Aluminium conducts heat 1000 times better than conventional inside walls made from wood.

Carthago Personality

Distinctive, unmistakable, unique: a Carthago is THE face in the crowd. It is as individual as its owner. The evolutionary Carthago design sets standards that go beyond the motorhome industry. **Shape and function** combined into a perfect symbiosis. Powerful radiator grille and elegant cab mask, stylishly rounded transition from the side walls to the roof, offset sills and a sturdy rear – together with the subtle décor, this all combines to produce the

typical Carthago look with harmonious shapes and flowing lines.

Every detail is well thought-out. The main cabin window and hatches are flush-mounted in the side walls. Even the filler cap of the semi-integrated motorhomes is flush mounted. The rear lights finish off the vehicle with a light graphic in the Carthago C-design.



The Carthago curved roof Carthago awakens emotions with its unique and elegant design and the curved roof which is typical of the brand. It also increases the torsion resistance of the body, and there is less susceptibility to side wind. The perfect combination of design and practicality!



Carthago front shroud combines elegant design and high quality GRP construction. Thanks to the two shell insulation, the Carthago semi-integrated motorhomes guarantee the best living climate, even at low temperatures.



The Carthago front design represents uniqueness, connects and is immediately recognisable on the roads. The well shaped radiator grille emphasises the dynamics of the entire motorhome.

Your added value with Carthago

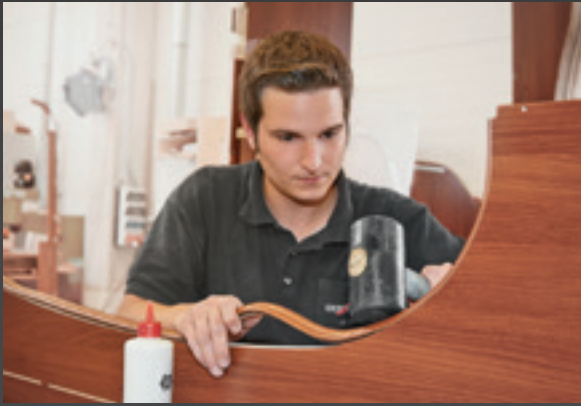

Workmanship quality: furniture from our own factory, manufactured and fitted piece by piece with meticulous craftsmanship – nothing wobbles or rattles. It is no coincidence that Carthago always achieves the best results for its outstanding processing quality. Carthago furniture design is a quality feature that is mentioned again and again. Extremely stable and designed for a long life thanks to the double connection technology.

- + **Striking and individual design concept**
- + **Elegance and dynamics**
due to the three-dimensional shapes and curves
- + **Flat bodywork surfaces**
due to invisibly recessed hinges and flush-mounted integrated tank flap
- + **Furniture made in our own Carthago factory**
- + **Stable “Durafix” double connection technology**
screwed in place and mortised
- + **No creaking or rattling while driving**
noise reduction by means of anti-knocking cushioning
- + **Stay, hinges and drawers**
with solid household quality
- + **Seating comfort on long journeys**
thanks to the ergonomically shaped quality upholstery
- + **Indirect lighting with LED lighting technology**
for a cosy atmosphere



LED lighting technology: bright reading light or cosy ambient lighting – the Carthago LED lighting technology makes it possible. Numerous spotlights in the right locations and effective indirect lighting in appropriate locations provide impressive effects. And this is also power-saving and long-lasting.

Powerful partners

First class partner for first class quality

A star cook only uses the best ingredients for a first class menu. Only selected components are also used for top class motorhomes. We have chosen strong partners for your Carthago - strong in performances, strong in quality and strong in service. So that you can enjoy your holiday in a Carthago in a relaxing way, just like

you would enjoy a Michelin-starred menu. Would you like to upgrade your Carthago into your own personal travel dream? If so, we recommend having your original Carthago accessories factory-installed.



Aguti
www.aguti.com



Aguti seats are multi-talented with regard to comfort, safety and ergonomics. They are specially tailored to the requirements of motorhomes, and fulfil all travelling and living requirements. The seats are guaranteed to provide healthy seating that supports your body, thanks to the anatomically adapted contact surfaces for the legs and back.

AL-KO

QUALITY FOR LIFE

Alois Kober GmbH
www.alko-tech.com



Carthago puts its trust in innovative AL-KO technology such as the AMC chassis with torsion bar suspension and individual wheel suspension for more comfort and safety and the high-strength and hot-dip galvanised AL-KO lightweight construction technology for more storage space and more payload. But also the innovative and modern hydraulic supports – and pneumatic suspension systems with intuitive operation.

alphatronics

alphatronics – Size in detail

www.alphatronics.de



All of the televisions in your Carthago motorhome are manufactured by alphatronics in Nuremberg. This ensures that you get consistently high quality, so that all your expectations of a reliable motorhome television are fulfilled. The “Made in Germany” quality claim does not just manifest itself during the manufacture of the devices, but starts during development. The company is always at the cutting edge due to having its own development department, and has been impressing its customers for years with innovations for the motorhome market.



DOMETIC

www.dometic.com



DOMETIC 10 series - keep it fresh, keep it cool. The new 10 series by Dometic has completely redefined the standards for mobile refrigerators: double sided door stop for access from both sides, aluminium handles over the entire height of the fridge, intuitive control with TFT display and the best cooling power in this class!



Super B
www.super-b.com



Super B supplies the lithium batteries for Carthago. The high-end lithium batteries provide tremendous energy reserves, and are much lighter, easy to install and have a considerably longer shelf life than other batteries. The Epsilon battery was specially developed for use in motorhomes. Due to the company's own intelligent battery management (BMS) and Bluetooth functionality, you are always kept informed about the current state of the battery and the amount of energy that is available. You will enjoy a high degree of self-sufficiency and optimum comfort on your trip with Carthago and Super B.



Teleco
www.telecogroup.com



The Teleco Group is one of Europe's leading companies in the camping accessories area. Teleco stands for quality products in the areas of satellite systems, televisions, air conditioning systems and generators. Particularly in satellite systems and televisions, the products excel because of their high quality, precision and innovative technology. More than 40 years of experience and a pan-European service network make Teleco a reliable partner. This is why Carthago puts its trust in its satellite systems.



Thule

www.thule.com



Travelling with your leisure vehicle means freedom: you can start whenever you want, and go wherever you want. You can stop in the most beautiful locations and enjoy living outdoors. A Thule awning is the perfect way to have a protected area next to your vehicle. Check out our smart blockers, tents, bike racks and much more!



**Truma Gerätetechnik
GmbH & Co. KG**

www.truma.com



Experience all that nature has to offer outside, and enjoy the highest levels of comfort inside: our Combi heaters and roof-mounted air conditioning systems make your holiday a carefree camping experience. The best example: the Truma Aventa comfort cools your motorhome extremely quickly and reliably with a powerful 2,400 W. Our 800 or so employees do their best every day to provide you with reliable premium products and excellent service.

This information is subject to price, design and equipment modifications and also errors. The details concerning scope of supply, appearance and performance correspond to the state of knowledge at the time of printing. If our suppliers change product designations during the season, we reserve the right to deliver a part type of equivalent value.



Visit your local Carthago
dealer and experience the
Carthago premium classes!



Carthago Reisemobilbau GmbH

www.carthago.com

Notes on the details in this catalogue: since the compilation of this catalogue in July 2020, changes may have been made to the product. Construction and design changes, differences in shade, as well as changes to the scope of supply on the part of the manufacturer remain subject to change during the delivery period. Differences in colour may be related to printing technicalities. Please note that the vehicles are sometimes pictured with special equipment that has an additional cost. More technical information, also for details about seating whilst driving, etc. can be found in the respectively applicable price list. This data complies with the German Road Traffic Regulations and Road Traffic Licensing Regulations.

⁽¹⁾ Patent/patent application is country-specific

© Carthago Reisemobilbau GmbH. 88326 Aulendorf, Tel. +49 7525 9200-0

Printed in Germany.

www.carthago.com